

MERLE K. "MUDHOLE" SMITH AIRPORT AIRPORT LAYOUT PLAN CORDOVA AIRPORT

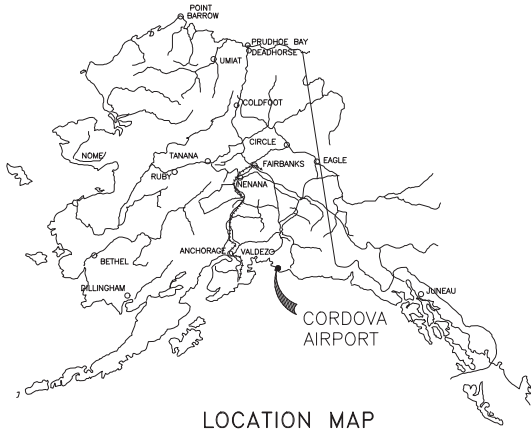

LOCATION MAP

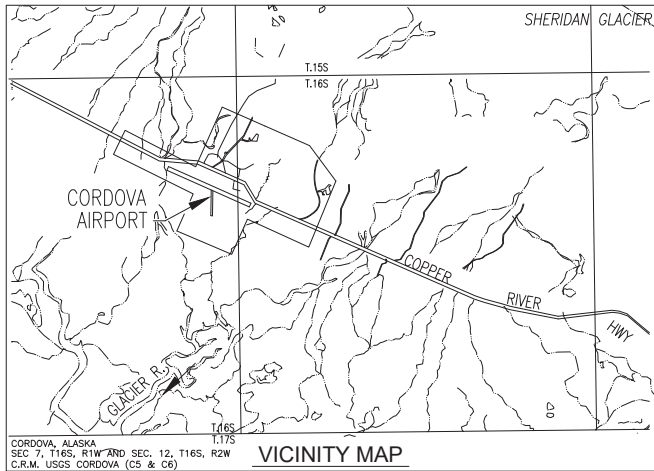

VICINITY MAP

LEGEND		
ITEM	EXISTING	ULTIMATE
AIRPORT REFERENCE POINT (A.R.P.)	●	⊙
BUILDINGS	■	SAME
BUILDING RESTRICTION LINE	— · — · — ·	SAME
CONTOURS	100	SAME
FENCING	— x — x — x	— x — x — x
LEASE LOT LINES	— · — · — ·	SAME
MONUMENT	●	
MONUMENT (PAC)	●	
ODALS	○	
PROPERTY LINE	— · — · — ·	— · — · — ·
REIL	●	
ROADWAYS	===	SAME
ROTATING BEACON	⊙	SAME
SECURITY GATE	⊙	SAME
SHORELINE	— · — · — ·	— · — · — ·
THRESHOLD LIGHTS	● ● ● ● ● ● ● ● ● ●	● ● ● ● ● ● ● ● ● ●
VASI	■ ■ ■ ■	
WIND CONE	⊙	SAME
SEGMENTED CIRCLE	⊙	SAME
ANTENNAE/TOWERS	△	
ILS/CRITICAL ZONES	— · — · — ·	
PAVEMENT		▨ ▨ ▨ ▨
HELIPORT	⊙	⊙
OVERHEAD POWER	— □ — □ — □	
EMAS	□	
PAPI		○ ○ ○ ○
TREES/BRUSHLINE	~ ~ ~ ~	
OPEN WATER	~~~~~	SAME

SHEET INDEX	
SHEET NO.	DESCRIPTION
1	COVER
2	AIRPORT DATA
3	EXISTING AIRPORT LAYOUT PLAN AIRPORT PLAN AND RUNWAY PROFILE
4	ULTIMATE AIRPORT LAYOUT PLAN AIRPORT PLAN AND RUNWAY PROFILE
5	AIRPORT AIRSPACE DRAWING
6	EXISTING INNER PORTION OF APPROACH SURFACE DRAWING - RUNWAY 9/27
7	ULTIMATE INNER PORTION OF APPROACH SURFACE DRAWING - RUNWAY 9/27
8	EXISTING/ULTIMATE INNER PORTION OF APPROACH SURFACE DRAWING - RUNWAY 9/27
9	EXISTING TERMINAL AREA PLAN
10	ULTIMATE TERMINAL AREA PLAN
11	LAND USE PLAN

DRAWING NAME: R:\Info_Communications\Cordova_02_ALP_Final_2019-11-21-AS-Built\ALP_02-AS-Built.dwg PLOTTED: Apr 02, 2020 - 2:03pm

DESIGN_EIG_JGL		
DRAWN_SMT	10/02/18	AS-BUILT PROJECT
CHECKED_ZWS	10/12/10	DATUM ADJUSTMENT
	6/1/09	AS-BUILT
BY	DATE	REVISIONS

STATE OF ALASKA	
DEPARTMENT OF TRANSPORTATION AND PUBLIC FACILITIES	
NORTHERN REGION	
APPROVED	DATE 4/17/2020
<i>Albert Beck</i>	
ALBERT BECK, P.E.	PROJECT DELIVERY CHIEF

AS-Built ALP Accepted

AIRPORTS DIVISION,
ALASKAN REGION, AAL-601
AIRSPACE REVIEW #03AAL-166NRA

THIS ALP SUPERSEDES ALP SIGNED 05/15/12.

THIS ALP IS BASED ON THE 2006 PROJECT RECORD DRAWINGS: RUNWAY SAFETY AREA IMPROVEMENTS AND EMAS INSTALLATION PHASE I-61485, PHASE II-62788, AND 2016 PROJECT RECORD DRAWINGS: APRON TAXIWAY AND GA IMPROVEMENTS STAGE II - 61403

MERLE K. "MUDHOLE" SMITH AIRPORT
CORDOVA, ALASKA

COVER

SHEET

1 OF 11

DRAWING NAME: R:\Info_Corrections\Aerial\02_ALP_Fld_2018-11-11_Aerial\02_700316-COV_ALP-AS-Built.dwg PLOTTED: Apr 03, 2020 - 2:04pm

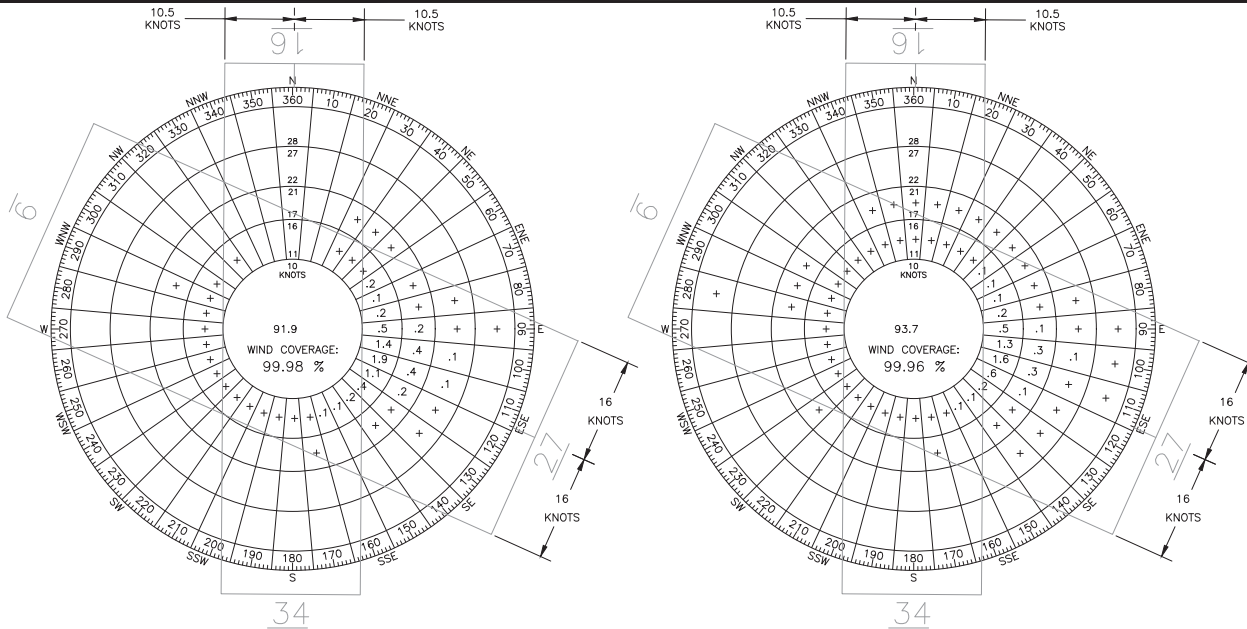

RUNWAY	10.5 kt	13 kt	16 kt
9/25	99.52%	99.81%	99.98%
16/34	94.61%	-	-
COMBINED	99.78%	99.81%	99.98%

SOURCE: NDCG ISH/ISD INVENTORY
STATION: MK (MUDHOLE) SMITH AIRPORT
PERIOD: 2008-2017

RUNWAY	10.5 kt	13 kt	16 kt
9/25	99.53%	99.82%	99.96%
16/34	93.13%	-	-
COMBINED	99.73%	99.82%	99.96%

SOURCE: NDCG ISH/ISD INVENTORY
STATION: MK (MUDHOLE) SMITH AIRPORT
PERIOD: 2008-2017

ITEM	EXISTING	STANDARD	ULTIMATE
R/W 9/27 SAFETY AREA LENGTH	9000' (1)	9500'	9000' (1)
R/W 9/27 LINE OF SIGHT STANDARD	NONSTANDARD (2)	(2)	(2)
R/W 16/34 SAFETY AREA LENGTH	1900'	2360'	2360'
R/W 16/34 SAFETY AREA WIDTH	30'	120'	120'
R/W 16/34 RUNWAY WIDTH	30'	60'	60'

(1) EMAS WAS INSTALLED IN LIEU OF SAFETY AREA EXTENSION BEYOND THE R/W 9 THRESHOLD. THE EXISTING RSA LENGTH BEYOND THE R/W 9 THRESHOLD IS 500', WHICH IS LESS THAN THE STANDARD OF 600' REQUIRED FOR EMAS. THIS IS A NONSTANDARD EMAS INSTALLATION.

(2) THE EXISTING RUNWAY 9/27 DOES NOT MEET LONGITUDINAL LINE OF SIGHT STANDARDS. THIS WILL BE CORRECTED UNDER A FUTURE RUNWAY RECONSTRUCTION PROJECT (6-20 YEAR PLANNING HORIZON).

- NOTES**
- NO OFZ OBJECT PENETRATIONS.
 - NO THRESHOLD SITING SURFACE OBJECT PENETRATIONS.
 - HORIZONTAL DATUM IS NAD83 (CORS96) (EPOCH2003.0) HOLDING THE AVERAGE OF THREE OPUS SOLUTIONS FOR NGS STATION "CORD" (PACS, PID: UW8134) AS 60°29'37.37993"N, 145°28'31.54038"W. VERTICAL DATUM IS NAVD88 DERIVED FROM GEOID06AK AND THE PUBLISHED NAD83(94) HEIGHT OF NGS STATION "CORD" (PACS, PID: UW8134) AS 54.20 NAVD88. THE HORIZONTAL AND VERTICAL CONTROL BASIS WERE DETERMINED BASED ON COMMENTS WITHIN THE UDF FILE REPRESENTING THE CURRENT NGS/FAA OBSTRUCTION SURVEY PUBLISHED JUNE 9, 2005 AND VERIFIED BY A USKH GROUND SURVEY OF RUNWAY 09-27 ENDS. CONTROL SURVEY PERFORMED BY USKH DURING AUGUST 2010. NOTE THAT THE PUBLISHED HORIZONTAL POSITION FOR NGS STATION "CORD" (PACS, PID: UW8134) WAS DECLARED TO BE OUT OF TOLERANCE BY THE NGS/FAA AND HAS NOT BEEN HONORED.
 - ELEVATIONS AND TOPOGRAPHY SHOWN HEREIN ARE BASED ON SURVEYS PERFORMED BY USKH DURING 2003 THROUGH 2005.
 - DISTANCES ARE HORIZONTAL GROUND DISTANCES IN US SURVEY FEET.
 - NAD83 ALASKA STATE PLANE ZONE 3 GRID BEARING OF RUNWAY 09-27 IS S 66°13'32" E.

DATA TABLES

RUNWAY DATA

ITEM	RUNWAY 9-27		RUNWAY 16-34	
	EXISTING	ULTIMATE	EXISTING	ULTIMATE
FAR PART 77 CATEGORY	OTHER THAN UTILITY-PR	SAME	UTILITY-VISUAL	ULTIMATE
IAP SURVEY REQUIRED	ANP, MIN.-27	SAME	NONE	SAME
UP SURVEY SOURCE	N/A--NO IAP CHANGE	REC'D-9	N/A	N/A
RUNWAY SURFACE	ASPHALT	SAME	GRAVEL	SAME
PAVEMENT STRENGTH	SINGLE WHEEL (S)	40,823	SAME	N/A
	(lb.)	90,000	SAME	N/A
	DUAL WHEEL (D)	69,400	SAME	N/A
DUAL TANDEM (DT)	(lb.)	133,000	SAME	N/A
	kg	127,010	SAME	N/A
	(lb.)	280,000	SAME	N/A
PCN	94/F/A/X/T	SAME	N/A	N/A
TOUCHDOWN ZONE ELEVATION (TDZE)	RUNWAY 09	50.0'	48.0'	N/A
	RUNWAY 16	N/A	N/A	52.5'
	RUNWAY 34	N/A	N/A	52.5'
				52.5'
EFFECTIVE GRADE	0.20%	SAME	0.53%	SAME
% WIND COVERAGE	99.5% (13 KNOTS)	SAME	93.3% (10.5 KNOTS)	SAME
APPROACH	34:1-09, 50:1-27	34:1-09, 50:1-27	20:1	SAME
VISIBILITY MINIMUMS	≥ 1 MILE-09	≥ 3/4 MILE-09	≥ 1 MILE	SAME
	≥ 1/2 MILE-27	≥ 1/2 MILE-27	≥ 1 MILE	SAME
RUNWAY MARKING	PR	SAME	NONE	SAME
RUNWAY LIGHTING	H.I.R.L.	SAME	NONE	SAME
NAVIGATION APPROACH AIDS	RUNWAY 09	ODALS,VASI,REIL	ODALS,PAPI,REIL,GPS	NONE
	RUNWAY 27	ILS/DME, NDB GPS, VASI, MALS/R	ILS/DME, NDB GPS, PAPI, MALS/R	SAME
RUNWAY DIMENSION	150' x 7500'	150' x 7500'	30' x 1899'	60' x 1899'
RUNWAY SAFETY AREA (RSA)				
- WIDTH	500'	SAME	30'	120'
- LENGTH BEYOND RUNWAY END	500'-9, 1000'-27	SAME	0'	240'
RUNWAY OBJECT FREE AREA (ROFA)				
- WIDTH	800'	SAME	250'	SAME
- LENGTH BEYOND RUNWAY END	9-500', 27-1000'	SAME	240'	SAME
RUNWAY OBSTACLE FREE ZONE (ROFZ)				
- WIDTH	400'	SAME	250'	SAME
- LENGTH BEYOND RUNWAY END	200'	SAME	200'	SAME
RUNWAY PROTECTION ZONE (RPZ)				
RUNWAY 09	1510'x1700'x1000'	SAME		
RUNWAY 27	1750'x2500'x1000'	SAME	450'x1000'x250'	SAME
RUNWAY 16			450'x1000'x250'	SAME
RUNWAY 34				
PRECISION OBJECT FREE ZONE (POFZ)	200'x800'-27	SAME	NONE	SAME
GEODETIC POSITIONS (NAD 83)				
THRESHOLD 9	LAT. 60°29'48.16"N	SAME		
	LONG. 145°29'46.29"W	SAME		
THRESHOLD 27	LAT. 60°29'17.85"N	SAME		
	LONG. 145°27'31.76"W	SAME		
THRESHOLD 16	LAT. 60°29'29.30"N	SAME		
	LONG. 145°28'35.71"W	SAME		
THRESHOLD 34	LAT. 60°29'10.61"N	SAME		
	LONG. 145°28'36.16"W	SAME		

AIRPORT DATA

ITEM	EXISTING	ULTIMATE
AIRPORT IDENTIFIER (CAO/U.S.)	PACV/CDV	SAME
AIRPORT ELEVATION (MSL)	54'	51'
AIRPORT REFERENCE POINT (ARP) - NAD 83	LAT. 60°29'30.4"N	
ULTIMATE R/W 9/27 STA. 111+79.47, 242.01' RT.	LONG. 145°28'39.2"W	
MEAN MAX. TEMPERATURE, HOTTEST MONTH (JULY)	60°F	N/A
AIRPORT AND TERMINAL NAVIGATION AIDS	RVR,GS, NDB,ILS/DME	RVR,GS, NDB,ILS/DME, GPS
AIRPORT REFERENCE CODE (ARC)	C-III	C-III
AIRPORT LIGHTING	BEACON	SAME
TAXIWAY LIGHTING	MIL	SAME
MAGNETIC DECLINATION, 2005, CHANGING 0°19'W/YR.	22'E	N/A

AIRPORT SURVEY CONTROL

POINT	NAD83(CORS)		NAD83(CORS) AK ZONE 3		ELEV	DESCRIPTION
	LATITUDE (N)	LONGITUDE (W)	NORTHING	EASTING		
551	60°29'37.37993"	145°28'31.54038"W	2372723.287	1735005.717	54.20	Fd 3.5' BC[NGS]: CORD 1992
701	60°29'31.41563"	145°28'32.82971"	2372117.217	1734845.960	53.31	Fd 3.25' AC/[DOT]: No Markings
702	60°29'17.95157"	145°27'31.77317"	2370764.806	1738015.567	42.99	Fd 2.5' BC/[DOT]: "X"
703	60°29'48.15947"	145°29'48.28581"	2373787.728	1731153.382	42.27	Fd 5/8' Rbr: No Cap

NOTE: POINTS SHOWN IN THE SURVEY CONTROL TABLE REPRESENT RECOVERED MONUMENTS AND DIFFER FROM PUBLISHED RUNWAY THRESHOLD POINTS SHOWN IN THE RUNWAY DATA TABLE.

DESIGN: EUG, JGL

DRAWN: SMT

CHECKED: ZWS

BY	DATE	REVISIONS
	10/02/18	AS-BUILT PROJECT
	10/12/10	DATUM ADJUSTMENT
	6/1/09	AS-BUILT

STATE OF ALASKA
DEPARTMENT OF TRANSPORTATION AND PUBLIC FACILITIES
NORTHERN REGION

APPROVED: *Albert Beck* DATE: 4/17/2020
ALBERT BECK, P.E. PROJECT DELIVERY CHIEF

AIRPORT LAYOUT PLAN
APPROVED BY LETTER DATED: _____

AIRPORTS DIVISION, AAL-601
ALASKAN REGION, AAL-601
AIRSPACE REVIEW #03AAL-166NRA

THIS ALP SUPERSEDES ALP SIGNED 05/15/12.

THIS ALP IS BASED ON THE 2006 PROJECT RECORD DRAWINGS: RUNWAY SAFETY AREA IMPROVEMENTS AND EMAS INSTALLATION PHASE I-61485, PHASE II-62788, AND 2016 PROJECT RECORD DRAWINGS: APRON TAXIWAY AND GA IMPROVEMENTS STAGE II - 61403

MERLE K. "MUDHOLE" SMITH AIRPORT
CORDOVA, ALASKA
AIRPORT DATA

SHEET

2 OF 11

DRAWING NAME: R:\Info_Corrections\Corrections\02_ALP_Fin_2019-11-21_48\BUILUP\034700136-COV_ALP-AS-BUILT.dwg PLOTTED: Apr 17, 2020 - 9:00am

TAXIWAY DATA TABLE					
TAXIWAY	WIDTH	LENGTH	TSA WIDTH	TOFA WIDTH	AIRCRAFT DESIGN GROUP
B	75	900	171	259	IV
C	50	691	118	180	III
D-NORTH OF TXL	25	837	49	89	I
D-SOUTH OF TXL	50	805	118	183	III
TAXILANE L WEST	50	1258	118	162	III
TAXILANE L EAST	25	775	49	79	I
K	25	115	49	89	I

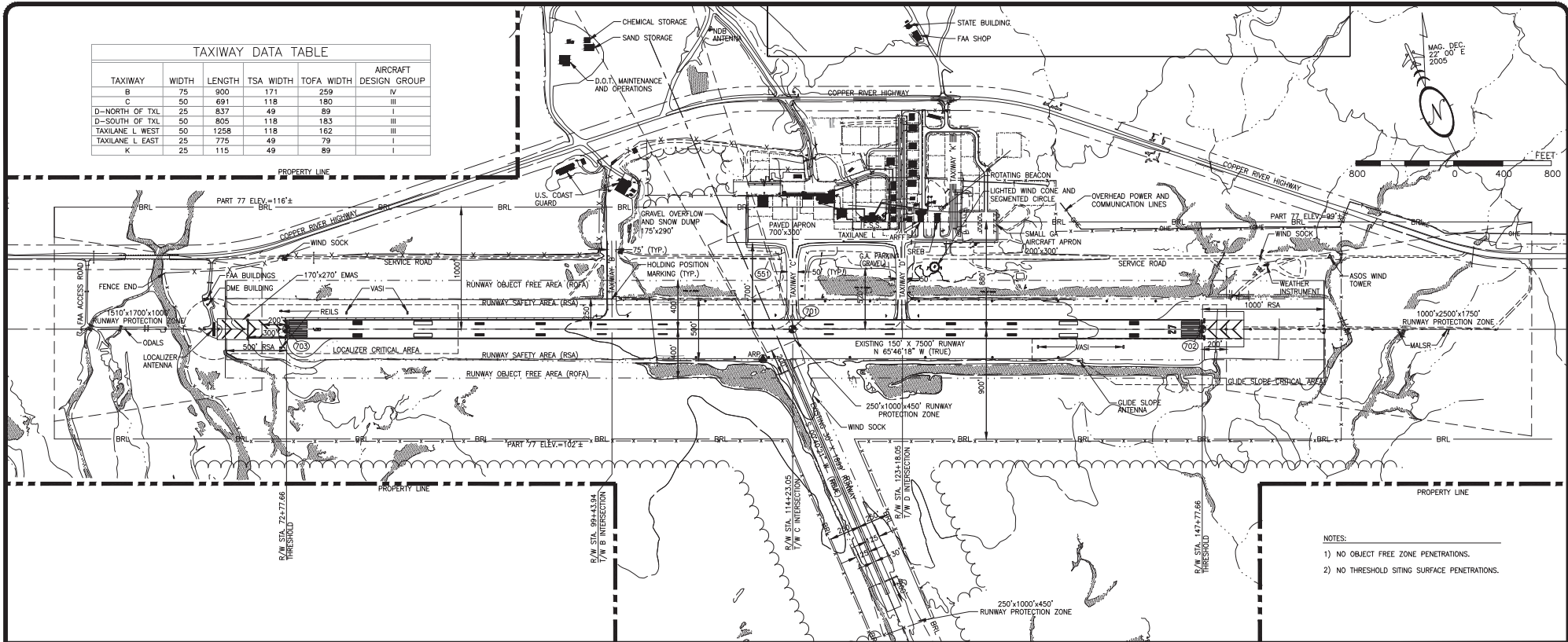

- NOTES:
- 1) NO OBJECT FREE ZONE PENETRATIONS.
 - 2) NO THRESHOLD SITING SURFACE PENETRATIONS.

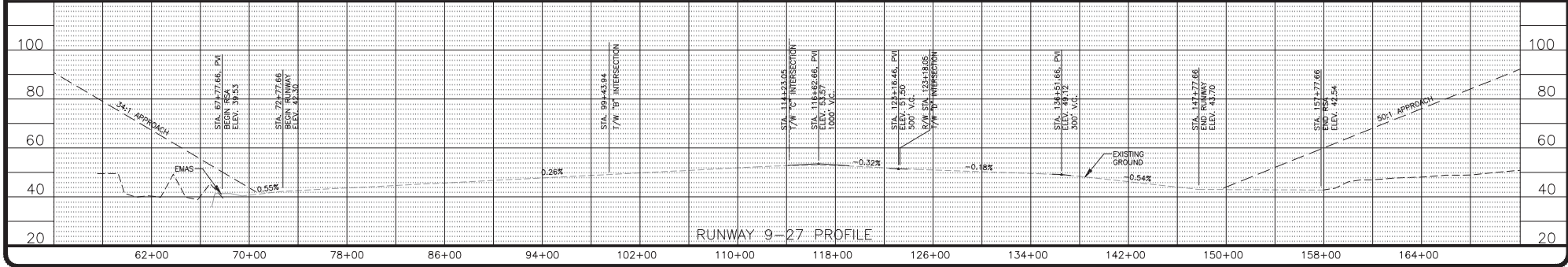

DESIGN_EIG_JGL			
DRAWN_SMT	10/02/18	AS-BUILT PROJECT	
CHECKED_ZWS	10/12/10	DATUM ADJUSTMENT	
	6/1/09	AS-BUILT	
BY	DATE	REVISIONS	

STATE OF ALASKA
DEPARTMENT OF TRANSPORTATION AND PUBLIC FACILITIES
NORTHERN REGION

APPROVED *Albert Beck* DATE 4/17/2020
ALBERT BECK, P.E. PROJECT DELIVERY CHIEF

AIRPORT LAYOUT PLAN
APPROVED BY LETTER DATED: _____

AIRPORTS DIVISION,
ALASKAN REGION, AAL-601
AIRSPACE REVIEW #03AAL-166NRA

THIS ALP SUPERSEDES ALP SIGNED 05/15/12.

THIS ALP IS BASED ON THE 2006 PROJECT RECORD DRAWINGS: RUNWAY SAFETY AREA IMPROVEMENTS AND EMAS INSTALLATION PHASE I-61485, PHASE II-62788, AND 2016 PROJECT RECORD DRAWINGS: APRON TAXIWAY AND GA IMPROVEMENTS STAGE II - 61403

MERLE K. "MUDHOLE" SMITH AIRPORT
CORDOVA, ALASKA

EXISTING AIRPORT LAYOUT PLAN
AIRPORT PLAN AND RUNWAY PROFILE

SHEET
3 OF 11

DRAWING NAME: R:\Info_Corrections\Corrections\02_ALP_Fin_2018-11-21_48\Bulldozer\03AAL-166NRA-001-AS-Built.dwg PLOTTED: Apr 17, 2020 - 9:08am

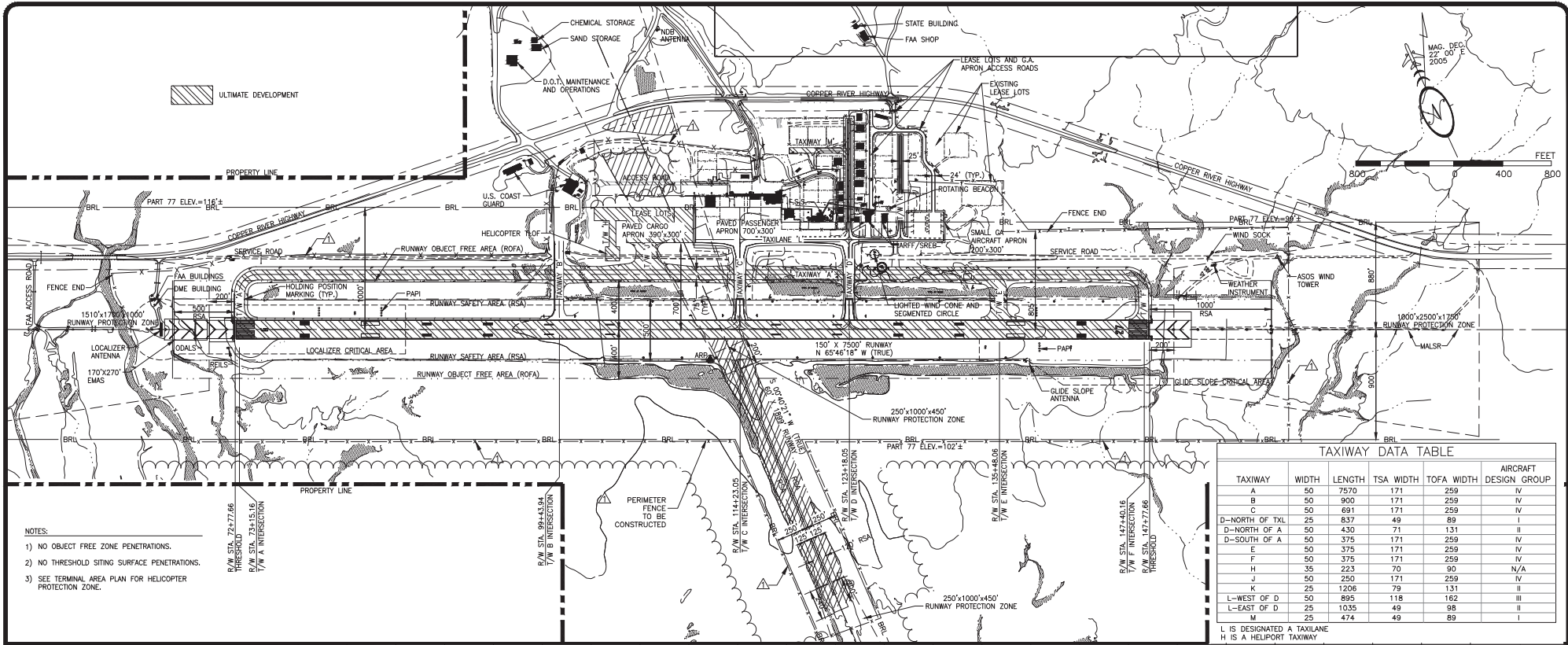

- NOTES:
- 1) NO OBJECT FREE ZONE PENETRATIONS.
 - 2) NO THRESHOLD SITING SURFACE PENETRATIONS.
 - 3) SEE TERMINAL AREA PLAN FOR HELICOPTER PROTECTION ZONE.

TAXIWAY	WIDTH	LENGTH	TSA WIDTH	TOFA WIDTH	AIRCRAFT DESIGN GROUP
A	50	7570	171	259	IV
B	50	900	171	259	IV
C	50	691	171	259	IV
D-NORTH OF TXL	25	837	49	89	I
D-NORTH OF A	50	430	71	131	II
D-SOUTH OF A	50	375	171	259	IV
E	50	375	171	259	IV
F	50	375	171	259	IV
H	35	223	70	90	N/A
J	50	250	171	259	IV
K	25	1206	79	131	II
L-WEST OF D	50	895	118	162	III
L-EAST OF D	25	1035	49	98	II
M	25	474	49	89	I

L IS DESIGNATED A TAXILANE
H IS A HELIPORT TAXIWAY

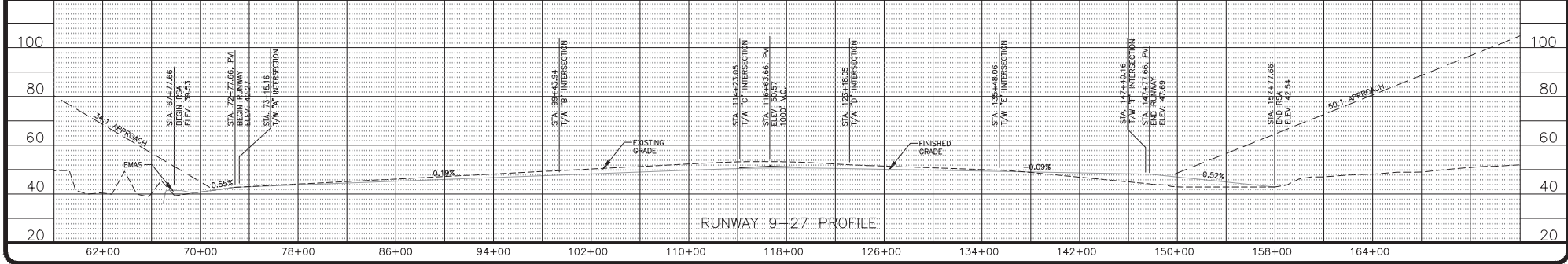

DESIGN_EIG_JGL DRAWN_SMT CHECKED_ZWS	<table border="1" style="width: 100%; border-collapse: collapse;"> <tr><td style="width: 15%;">10/02/18</td><td>AS-BUILT PROJECT</td></tr> <tr><td>04/04/16</td><td>FENCE LINE ADJUSTMENT</td></tr> <tr><td>10/12/10</td><td>DATUM ADJUSTMENT</td></tr> <tr><td>5/1/09</td><td>AS-BUILT</td></tr> </table>	10/02/18	AS-BUILT PROJECT	04/04/16	FENCE LINE ADJUSTMENT	10/12/10	DATUM ADJUSTMENT	5/1/09	AS-BUILT	STATE OF ALASKA DEPARTMENT OF TRANSPORTATION AND PUBLIC FACILITIES NORTHERN REGION APPROVED <i>Albert Beck</i> DATE 4/17/2020 ALBERT BECK, P.E. PROJECT DELIVERY CHIEF	AIRPORT LAYOUT PLAN APPROVED BY LETTER DATED: _____ AIRPORTS DIVISION, ALASKAN REGION, AAL-601 AIRSPACE REVIEW #03AAL-166NRA	THIS ALP SUPERSEDES ALP SIGNED 05/15/12. THIS ALP IS BASED ON THE 2006 PROJECT RECORD DRAWINGS: RUNWAY SAFETY AREA IMPROVEMENTS AND EMAS INSTALLATION PHASE I-61485, PHASE II-62788, AND 2016 PROJECT RECORD DRAWINGS: APRON TAXIWAY AND GA IMPROVEMENTS STAGE II - 61403	MERLE K. "MUDHOLE" SMITH AIRPORT CORDOVA, ALASKA ULTIMATE AIRPORT LAYOUT PLAN AIRPORT PLAN AND RUNWAY PROFILE	SHEET 4 OF 11
10/02/18	AS-BUILT PROJECT													
04/04/16	FENCE LINE ADJUSTMENT													
10/12/10	DATUM ADJUSTMENT													
5/1/09	AS-BUILT													

DRAWING NAME: RN, Info: Communications/Corridor/02 ALP_FHA_2019-11-21_4-Built/ALP_2019/03/16-COV_ALP-AS-Built.dwg PLOTTED: Apr 03, 2020 - 2:15pm

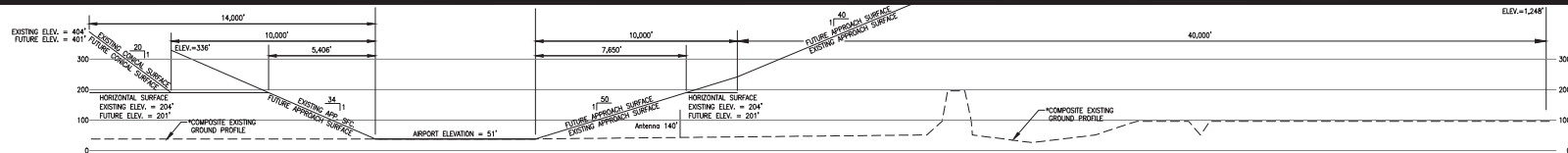

*THE COMPOSITE EXISTING GROUND PROFILE DEPICTS THE GROUND PROFILE ALONG THE EXTENDED RUNWAY CENTERLINE REPRESENTING THE HIGHEST TERRAIN ACROSS THE WIDTH AND ALONG THE LENGTH OF THE APPROACH SURFACE.

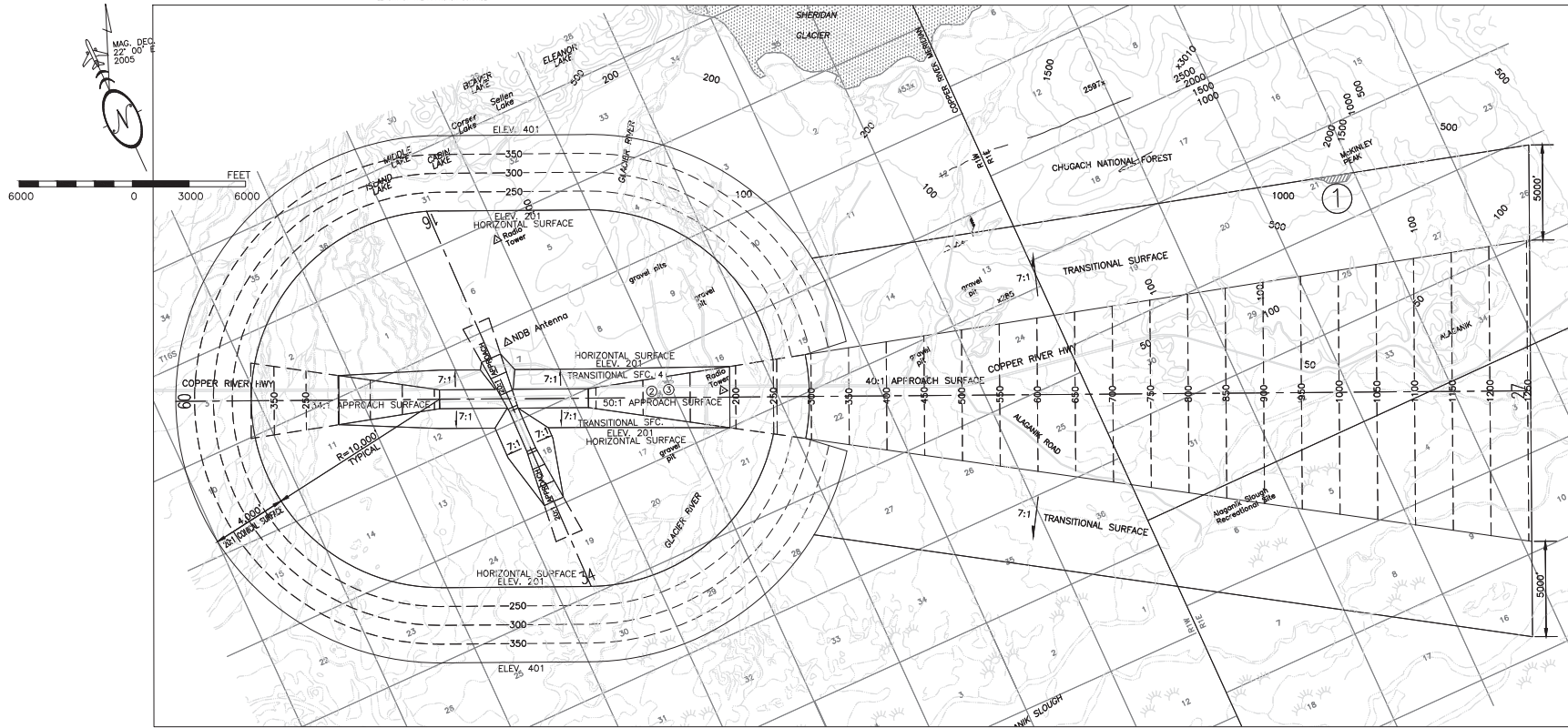

OBSTRUCTION DATA TABLE

NUMBER	PENETRATION DISTANCE	DESCRIPTION	DISPOSITION
①	286' MAXIMUM	TERRAIN	TO REMAIN
②	15' ±	TREES	REMOVE
③	25' ±	TREES	REMOVE
④	15' ±	TREES	REMOVE

REFER TO THE INNER PORTION OF THE APPROACH SURFACE PLAN FOR DETAILS OF CLOSE OBSTRUCTIONS.

LEGEND

- TERRAIN OBSTRUCTION
- GLACIER

DESIGN_EJG_JGL		
DRAWN_SMT	10/02/18	AS-BUILT PROJECT
	10/12/10	DATUM ADJUSTMENT
CHECKED_ZWS	5/1/09	AS-BUILT
BY	DATE	REVISIONS

STATE OF ALASKA
DEPARTMENT OF TRANSPORTATION AND PUBLIC FACILITIES
NORTHERN REGION

APPROVED DATE **4/17/2020**
ALBERT BECK, P.E. PROJECT DELIVERY CHIEF

AIRPORT LAYOUT PLAN
APPROVED BY LETTER DATED: _____

AIRPORTS DIVISION,
ALASKAN REGION, AAL-601
AIRSPACE REVIEW #03AAL-166NRA

THIS ALP SUPERSEDES ALP SIGNED 05/15/12.
THIS ALP IS BASED ON THE 2006 PROJECT RECORD DRAWINGS: RUNWAY SAFETY AREA IMPROVEMENTS AND EMAS INSTALLATION PHASE I-61485, PHASE II-62788, AND 2016 PROJECT RECORD DRAWINGS: APRON TAXIWAY AND GA IMPROVEMENTS STAGE II - 61403

MERLE K. "MUDHOLE" SMITH AIRPORT
CORDOVA, ALASKA
AIRPORT AIRSPACE DRAWING

DRAWING NAME: R/W Info; Comments: Cordova; CD ALP File: 2019-11-21_48BulbAlp_20170318-CDV_ALP-AS-Built.dwg; PLOTTED: Apr 02, 2020 - 2:16pm

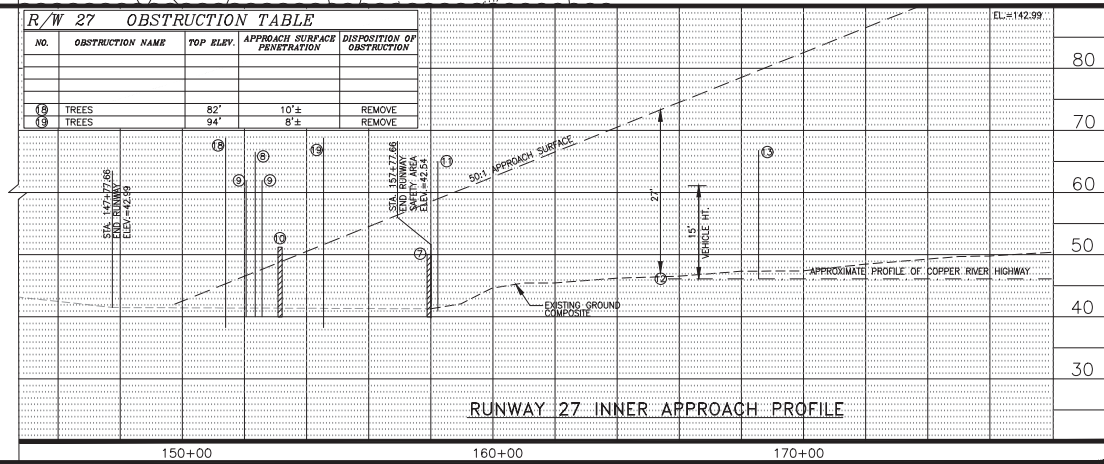
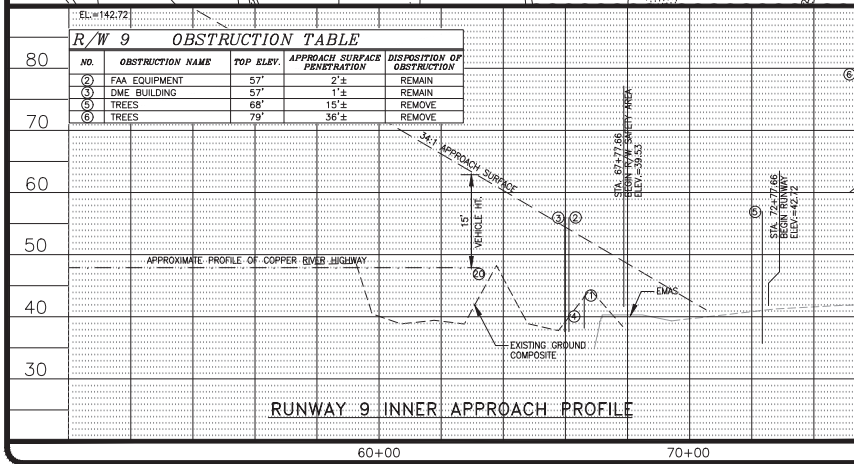
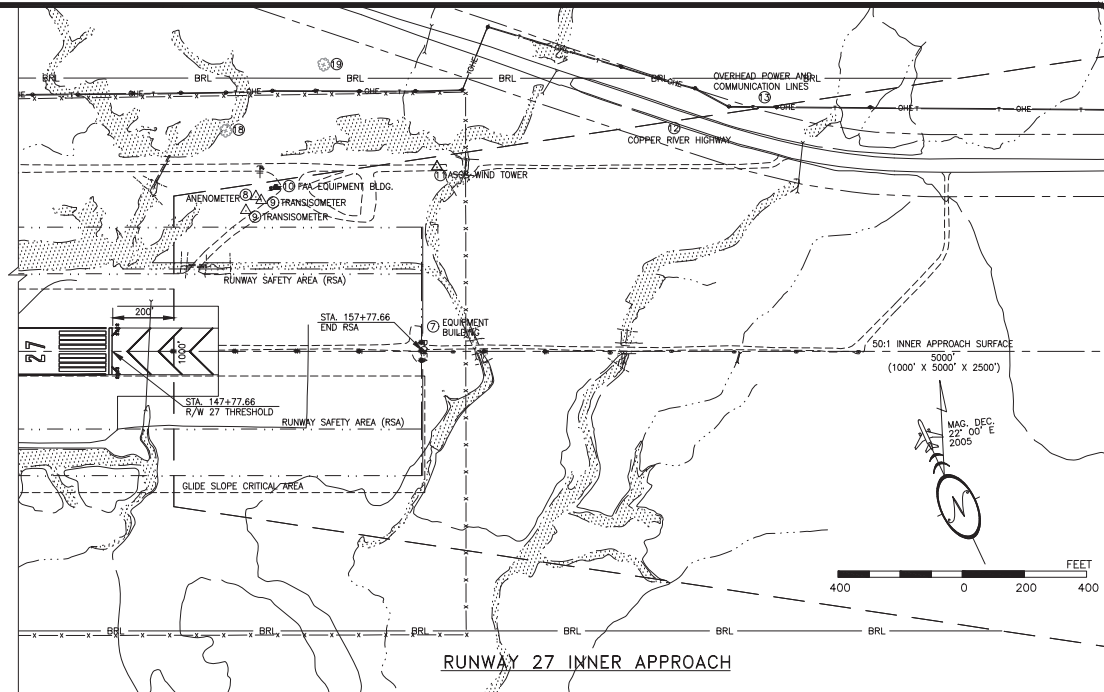
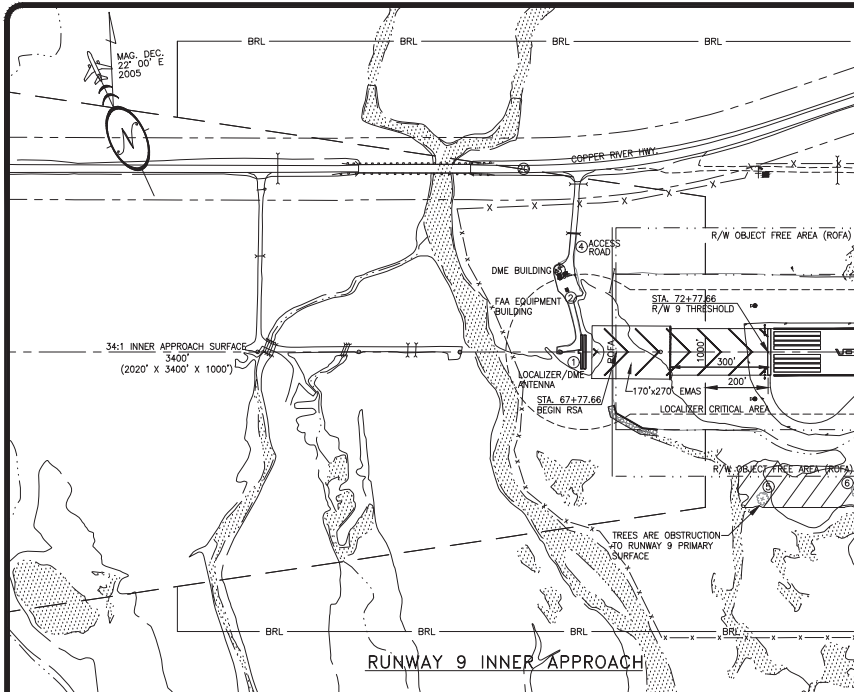

DESIGN: <u>EJG</u>		STATE OF ALASKA DEPARTMENT OF TRANSPORTATION AND PUBLIC FACILITIES NORTHERN REGION	AIRPORT LAYOUT PLAN APPROVED BY LETTER DATED: _____	THIS ALP SUPERSEDES ALP SIGNED 05/15/12. THIS ALP IS BASED ON THE 2006 PROJECT RECORD DRAWINGS: RUNWAY SAFETY AREA IMPROVEMENTS AND EMAS INSTALLATION PHASE I-61485, PHASE II-62788, AND 2016 PROJECT RECORD DRAWINGS: APRON TAXIWAY AND GA IMPROVEMENTS STAGE II - 61403	MERLE K. "MUDHOLE" SMITH AIRPORT CORDOVA, ALASKA EXISTING INNER PORTION OF THE APPROACH SURFACE DRAWING RUNWAY 9-27	SHEET 6 OF 11
DRAWN: <u>SMT</u>	10/02/18 AS-BUILT PROJECT	APPROVED: <u>Albert Beck</u> ALBERT BECK, P.E.	AIRPORTS DIVISION, ALASKAN REGION, AAL-601 AIRSPACE REVIEW #03AAL-166NRA			
CHECKED: <u>ZWS</u>	10/12/10 DATUM ADJUSTMENT	DATE <u>4/17/2020</u> PROJECT DELIVERY CHIEF				
BY: _____	DATE: _____	REVISIONS: _____				

DRAWING NAME: R:\Info_Corrections\Corrections\02_ALP_FHA_2018-11-21_A\B\B\ALP\02700318-COV_ALP-AS-BUILT.dwg PLOTTED: Apr 03, 2020 - 2:19pm

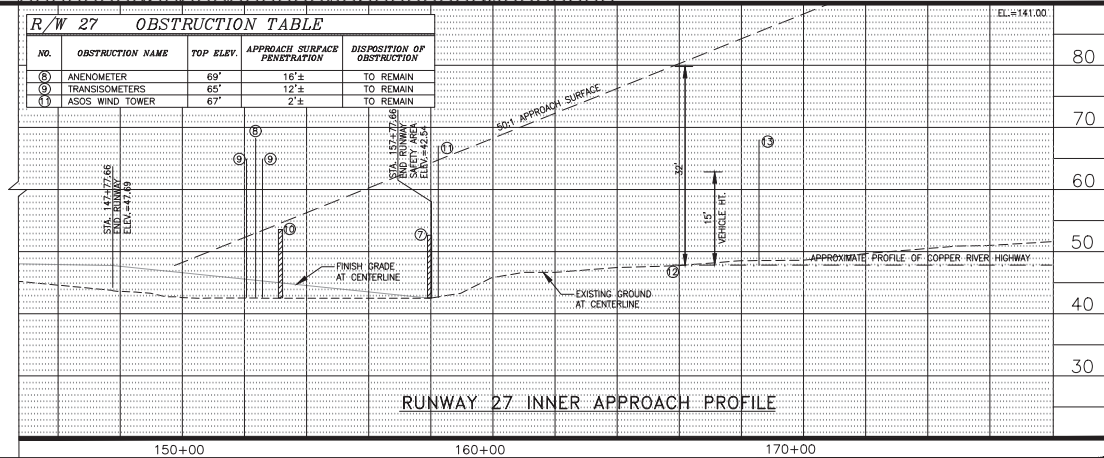
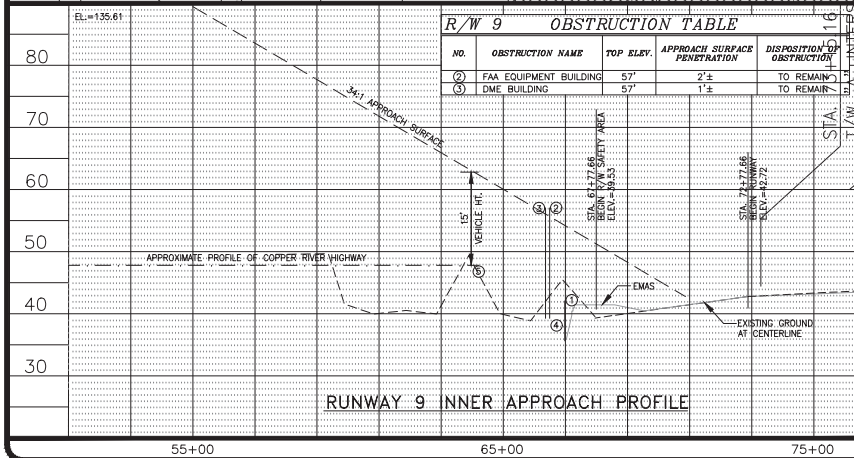
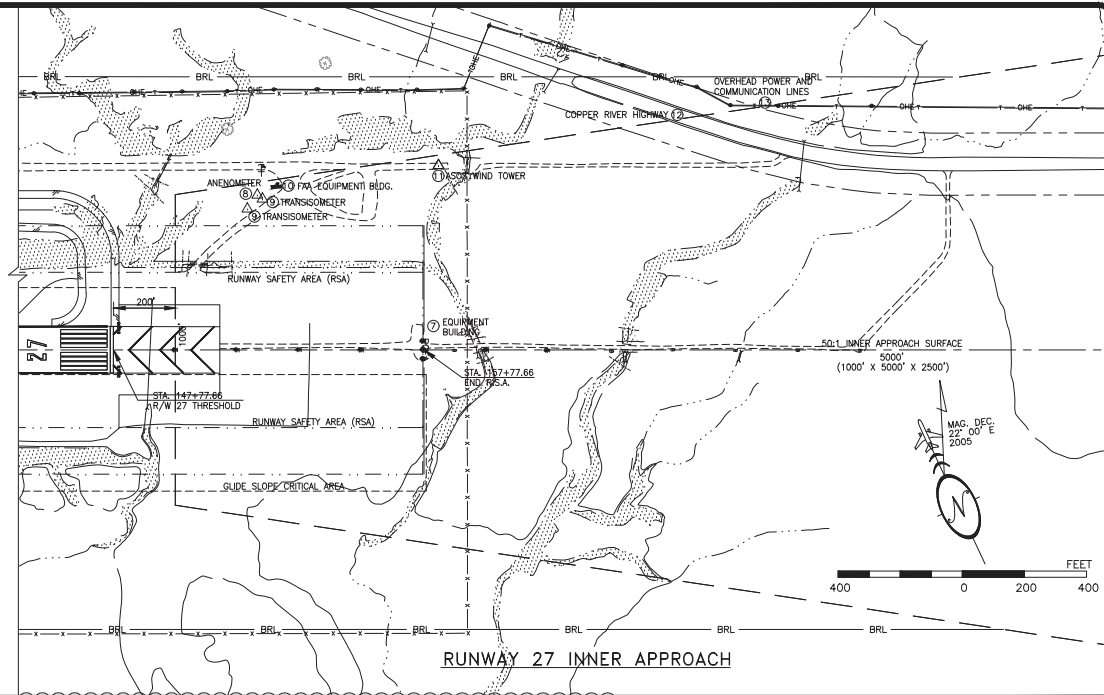
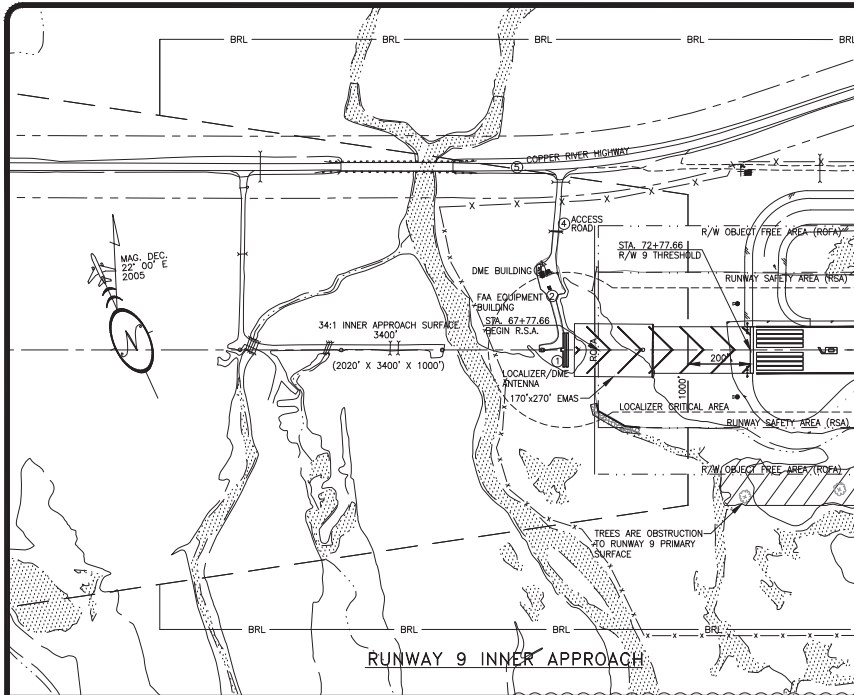

DESIGN_EIG_JGL		
DRAWN_SMT	10/02/18	AS-BUILT PROJECT
	10/12/10	DATUM ADJUSTMENT
CHECKED_ZWS	6/1/09	AS-BUILT
BY	DATE	REVISIONS

STATE OF ALASKA
DEPARTMENT OF TRANSPORTATION AND PUBLIC FACILITIES
NORTHERN REGION

APPROVED *Albert Beck*
ALBERT BECK, P.E. DATE **4/17/2020**
PROJECT DELIVERY CHIEF

AIRPORT LAYOUT PLAN
APPROVED BY LETTER DATED: _____

AIRPORTS DIVISION,
ALASKAN REGION, AAL-601
AIRSPACE REVIEW #03AAL-166NRA

THIS ALP SUPERSEDES ALP SIGNED 05/15/12.

THIS ALP IS BASED ON THE 2006 PROJECT RECORD DRAWINGS: RUNWAY SAFETY AREA IMPROVEMENTS AND EMAS INSTALLATION PHASE I-61485, PHASE II-62788, AND 2016 PROJECT RECORD DRAWINGS: APRON TAXIWAY AND GA IMPROVEMENTS STAGE II - 61403

MERLE K. "MUDHOLE" SMITH AIRPORT
CORDOVA, ALASKA

ULTIMATE INNER PORTION OF THE
APPROACH SURFACE DRAWING
RUNWAY 9-27

SHEET
7 OF 11

DRAWING NAME: R:\Info_Corrections\Corrections\02_ALP_FHA_2018-11-21_AlbBeck\02700336-COV_ALP-AS-Built.dwg PLOTTED: Apr 02, 2020 - 2:20pm

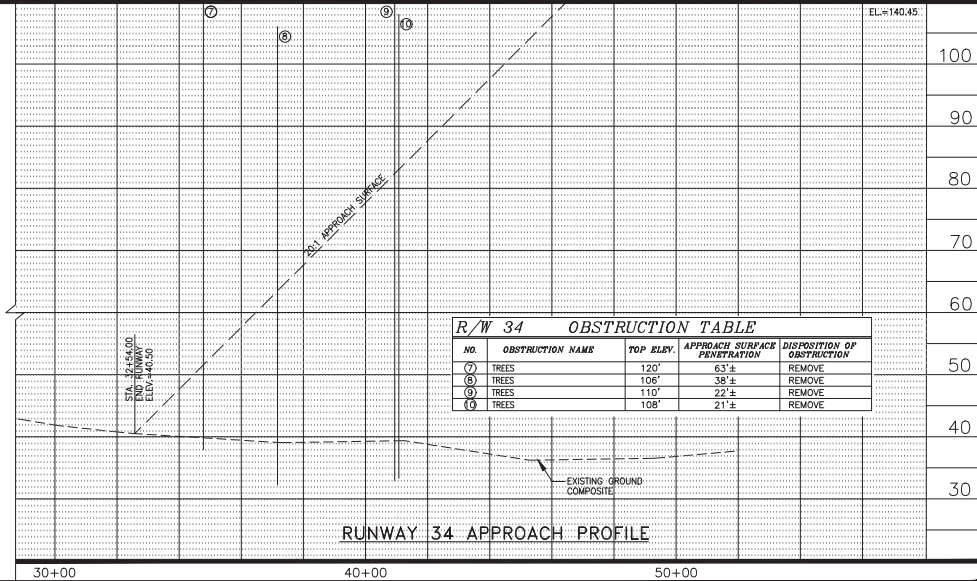
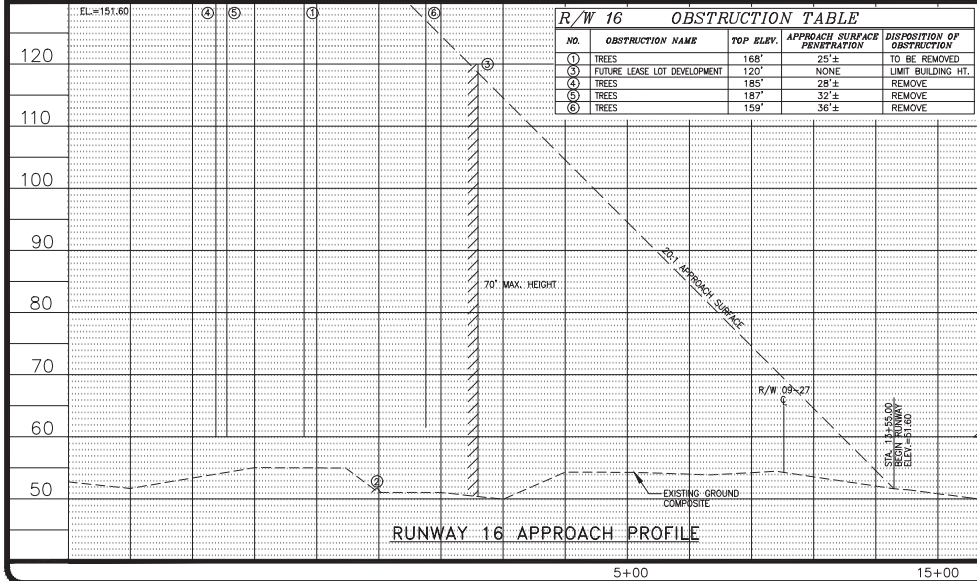
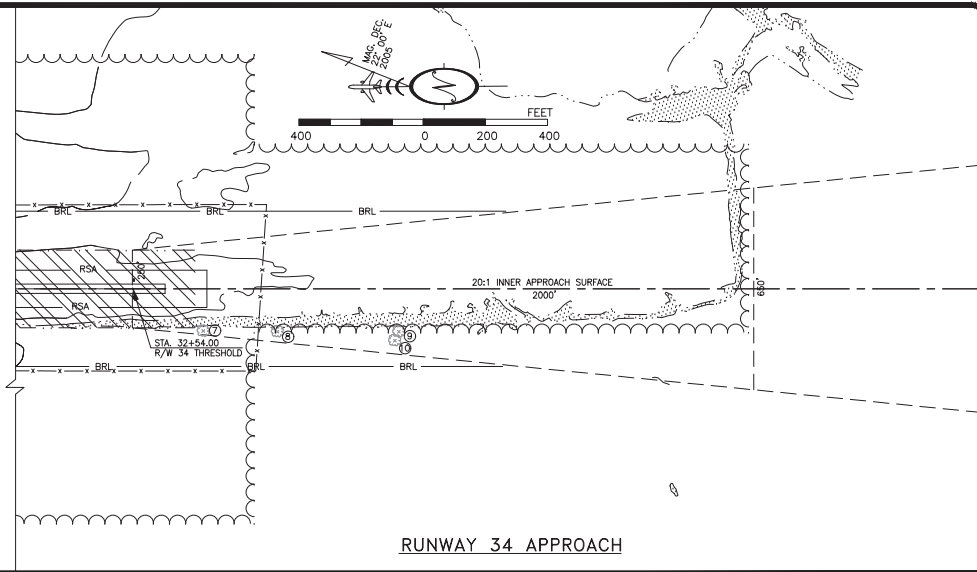
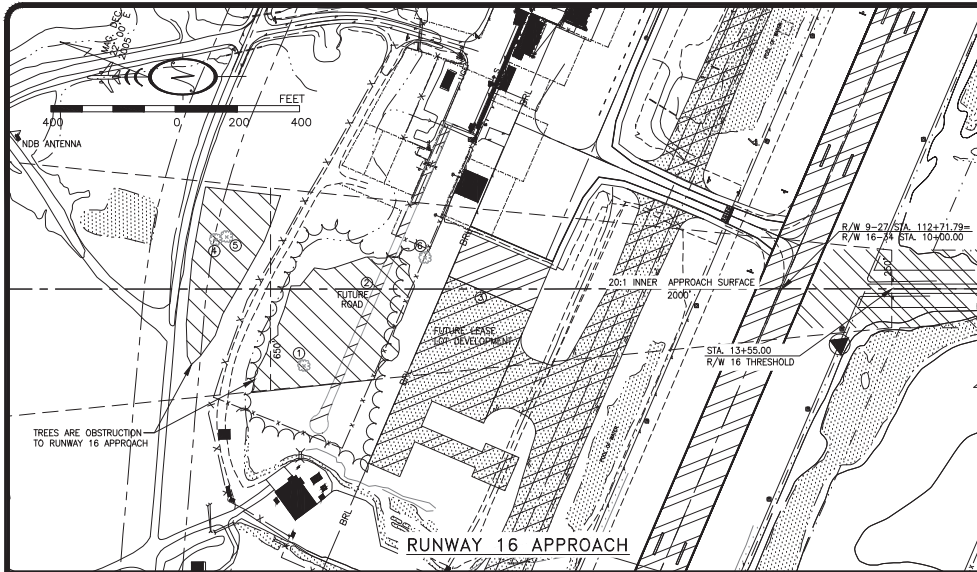

DESIGN_EIG_JGL			
DRAWN_SMT	10/02/18	AS-BUILT PROJECT	
	10/12/10	DATUM ADJUSTMENT	
CHECKED_ZWS	5/1/09	AS-BUILT	
BY	DATE	REVISIONS	

STATE OF ALASKA
DEPARTMENT OF TRANSPORTATION AND PUBLIC FACILITIES
NORTHERN REGION

APPROVED _____ DATE 4/17/2020
ALBERT BECK, P.E. PROJECT DELIVERY CHIEF

AIRPORT LAYOUT PLAN
APPROVED BY LETTER DATED: _____

AIRPORTS DIVISION,
ALASKAN REGION, AAL-601
AIRSPACE REVIEW #03AAL-166NRA

THIS ALP SUPERSEDES ALP SIGNED 05/15/12.
THIS ALP IS BASED ON THE 2006 PROJECT RECORD DRAWINGS: RUNWAY SAFETY AREA IMPROVEMENTS AND EMAS INSTALLATION PHASE I-61485, PHASE II-62788, AND 2016 PROJECT RECORD DRAWINGS: APRON TAXIWAY AND GA IMPROVEMENTS STAGE II - 61403

MERLE K. "MUDHOLE" SMITH AIRPORT
CORDOVA, ALASKA

EXISTING/ULTIMATE INNER PORTION OF THE
APPROACH SURFACE DRAWING
RUNWAY 16-34

SHEET
8 OF 11

DRAWING NAME: R:\Info_Correspondence\Coronado\02_ALP_Fin_2019-11-21_4-Building\020700306-COV_ALP-AS-Built.dwg PLOTTED: Apr 02, 2020 - 2:20pm

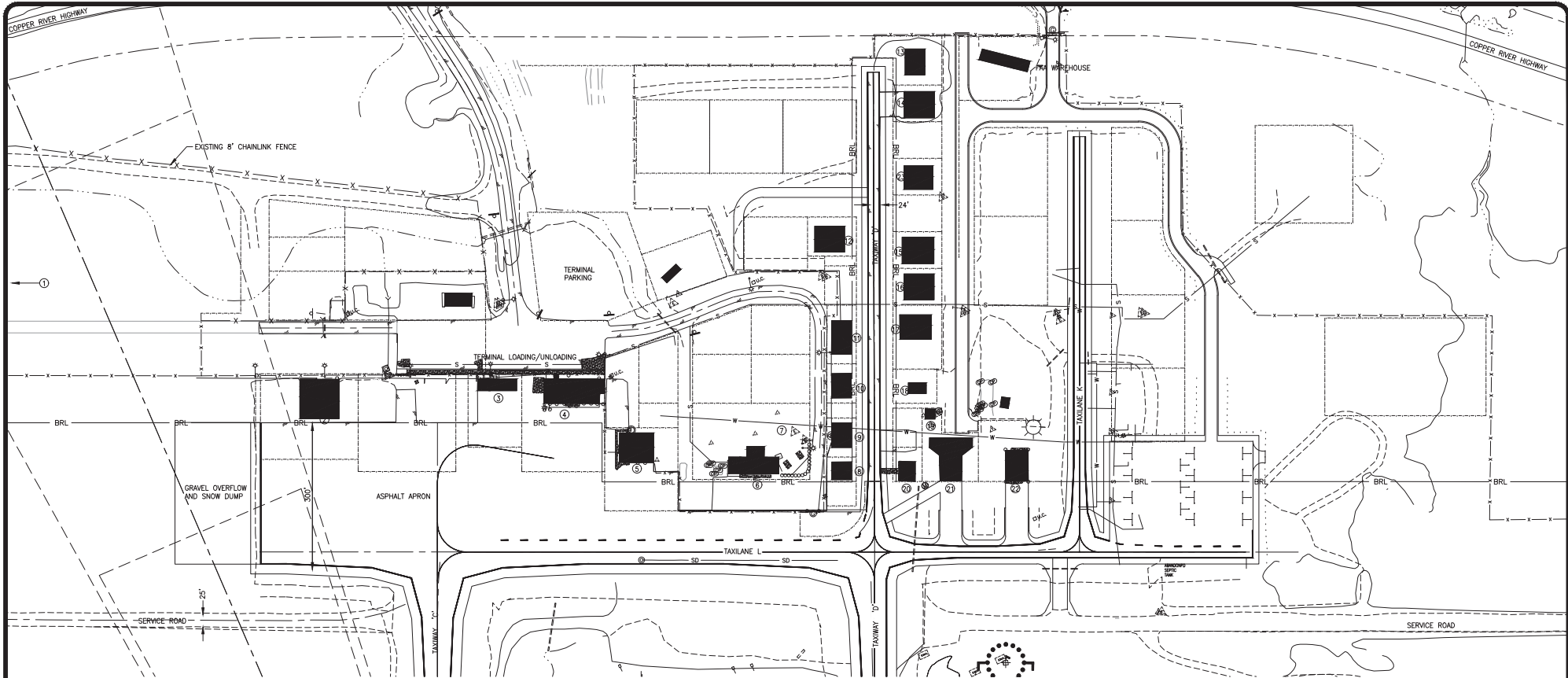

#	STRUCTURE NAME	TOP ELEV.	OBSTRUCTION WARNING (Y/N)		REMARKS
			EXISTING	ULTIMATE	
1	U.S. COAST GUARD HANGAR	ELEV.	N	N	
2	ALASKA WILDERNESS OUTFITTING	93.52	N	N	
3	GRAND SLAM, LLC	72.30	N	N	
4	ALASKA AIRLINES TERMINAL	70.63	N	N	
5	ALASKA AIRLINES BUILDING	76.83	N	N	
6	F.A.A./F.S.S.	70.32	N	N	
7	F.A.A./ANTENNA TOWERS	125.00	Y	Y	
8	HANGAR	83.85	N	N	
9	HANGAR	85.09	N	N	
10	HANGAR	84.93	N	N	
11	HANGAR	85.47	N	N	
12	HANGAR	86.19	N	N	
13	HANGAR	87.33	N	N	

#	STRUCTURE NAME	TOP ELEV.	OBSTRUCTION WARNING (Y/N)		REMARKS
			EXISTING	ULTIMATE	
14	HANGAR	89.09	N	N	
15	HANGAR	85.28	N	N	
16	HANGAR	85.10	N	N	
17	HANGAR	84.45	N	N	
18	FAA	68.44	N	N	
19	GENERATOR BUILDING	64.69	N	N	
20	ARFF OFFICE	68.43	N	N	
21	ARFF	84.52	N	N	
22	SREB	84.52	N	N	
23	HANGAR	85.49	N	N	
24					
25					
26					

DESIGN_EJG_JGL		
DRAWN_SMT	10/02/18	AS-BUILT PROJECT
CHECKED_ZWS	10/12/10	DATUM ADJUSTMENT
	6/1/09	AS-BUILT
BY	DATE	REVISIONS

STATE OF ALASKA
DEPARTMENT OF TRANSPORTATION AND PUBLIC FACILITIES
NORTHERN REGION

APPROVED *Albert Beck* DATE **4/17/2020**
ALBERT BECK, P.E. PROJECT DELIVERY CHIEF

AIRPORT LAYOUT PLAN
APPROVED BY LETTER DATED: _____

AIRPORTS DIVISION,
ALASKAN REGION, AAL-601
AIRSPACE REVIEW #03AAL-166NRA

THIS ALP SUPERSEDES ALP SIGNED 05/15/12.

THIS ALP IS BASED ON THE 2006 PROJECT RECORD DRAWINGS: RUNWAY SAFETY AREA IMPROVEMENTS AND EMAS INSTALLATION PHASE I-61485, PHASE II-62788, AND 2016 PROJECT RECORD DRAWINGS: APRON TAXIWAY AND GA IMPROVEMENTS STAGE II - 61403

MERLE K. "MUDHOLE" SMITH AIRPORT
CORDOVA, ALASKA
EXISTING TERMINAL AREA PLAN

SHEET
9 OF 11

DRAWING NAME: R:\Info_Consulting\Corvo\02_ALP_Fin_2018-11-21_4-Built\ALP_20170319-COV_ALP-AS-Built.dwg PLOTTED: Apr 02, 2020 - 2:22pm

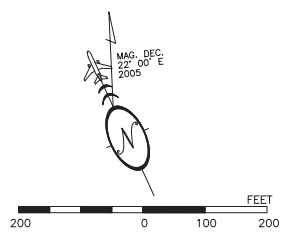
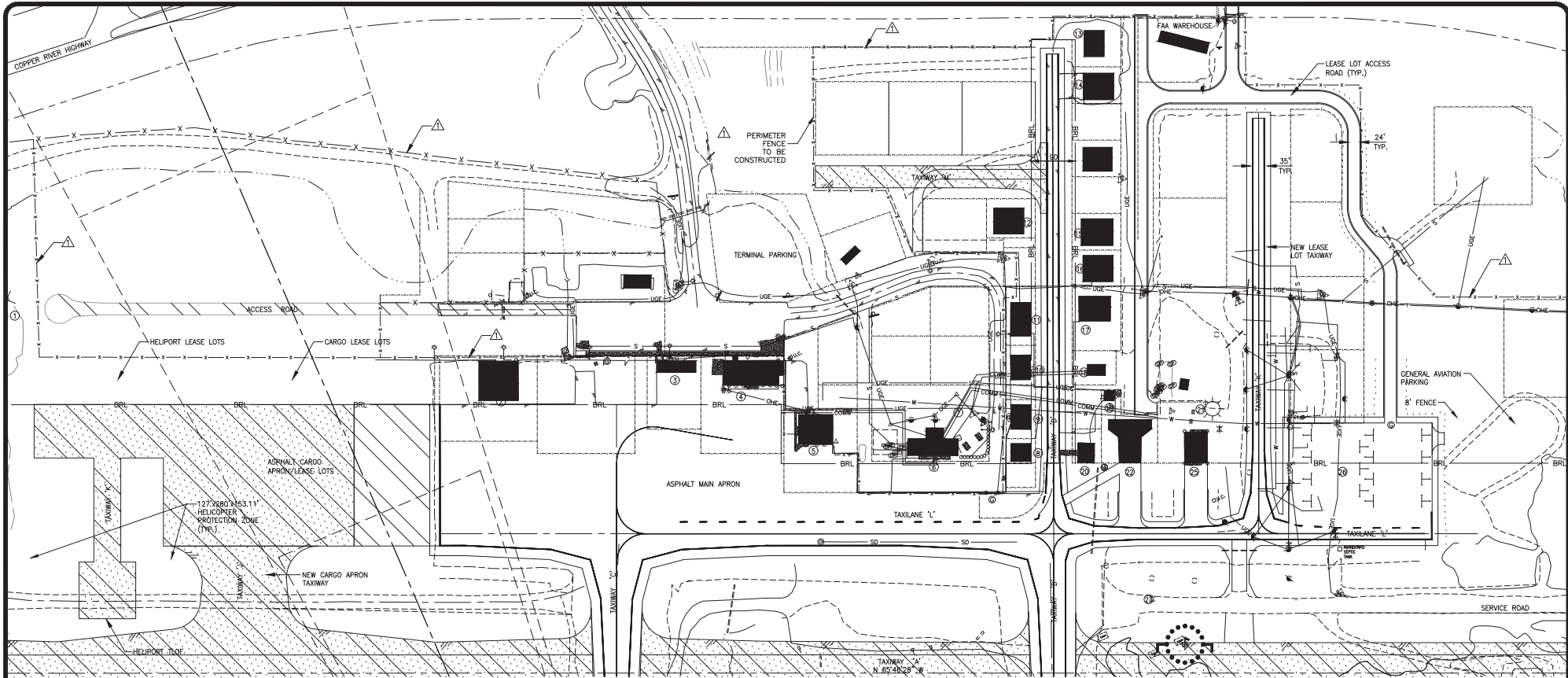

BUILDING DATA TABLE					
#	STRUCTURE NAME	TOP ELEV.	OBSTRUCTION WARNING (Y/N)		REMARKS
			EXISTING	ULTIMATE	
1	U.S. COAST GUARD HANGAR	ELEV.	N	N	
2	ALASKA WILDERNESS OUTFITTING	93.52	N	N	
3	GRAND SLAM, LLC	72.30	N	N	
4	ALASKA AIRLINES TERMINAL	70.63	N	N	
5	ALASKA AIRLINES BUILDING	76.93	N	N	
6	F.A.A./F.S.S.	70.32	N	N	
7	F.A.A./ANTENNA TOWERS	125.00	Y	Y	
8	HANGAR	83.85	N	N	
9	HANGAR	85.09	N	N	
10	HANGAR	84.93	N	N	
11	HANGAR	85.47	N	N	
12	HANGAR	86.19	N	N	
13	HANGAR	87.33	N	N	

BUILDING DATA TABLE					
#	STRUCTURE NAME	TOP ELEV.	OBSTRUCTION WARNING (Y/N)		REMARKS
			EXISTING	ULTIMATE	
14	HANGAR	89.09	N	N	
15	HANGAR	85.28	N	N	
16	HANGAR	85.10	N	N	
17	HANGAR	84.45	N	N	
18	FAA	68.44	N	N	
19	GENERATOR BUILDING	64.69	N	N	
20	ARFF OFFICE	68.43	N	N	
21	ROTATING BEACON	180.59	N	N	
22	ARFF	84.52	N	N	
23	WINDCONE/SEGMENTED CIRCLE	97.56	Y	Y	
24	HANGAR	85.49	N	N	
25	SREB BUILDING	84.52	N	N	
26	NEW ARFF/SREB	84.47	N	N	

DESIGN_EJG_JGL	
DRAWN_SMT	10/02/18 AS-BUILT PROJECT
CHECKED_ZWS	HPF 04/04/16 FENCE LINE ADJUSTMENT
	10/12/10 DATUM ADJUSTMENT
	6/1/09 AS-BUILT
BY DATE REVISIONS	

STATE OF ALASKA
DEPARTMENT OF TRANSPORTATION AND PUBLIC FACILITIES
NORTHERN REGION

APPROVED: *Albert Beck* DATE: 4/17/2020
ALBERT BECK, P.E. PROJECT DELIVERY CHIEF

AIRPORT LAYOUT PLAN
APPROVED BY LETTER DATED: _____

AIRPORTS DIVISION,
ALASKAN REGION, AAL-601
AIRSPACE REVIEW #03AAL-166NRA

THIS ALP SUPERSEDES ALP SIGNED 05/15/12.

THIS ALP IS BASED ON THE 2006 PROJECT RECORD DRAWINGS: RUNWAY SAFETY AREA IMPROVEMENTS AND EMAS INSTALLATION PHASE I-61485, PHASE II-62788, AND 2016 PROJECT RECORD DRAWINGS: APRON TAXIWAY AND GA IMPROVEMENTS STAGE II - 61403

MERLE K. "MUDHOLE" SMITH AIRPORT
CORDOVA, ALASKA

ULTIMATE TERMINAL AREA PLAN

SHEET 10 OF 11

NOTE: NON-AERONAUTICAL USE AREA APPROVED FOR A 25 YEAR PERIOD IN FAA LETTER DATED 7/18/2011.



AIRPORT BOUNDARY

COPPER RIVER HIGHWAY 200' WIDE ROW

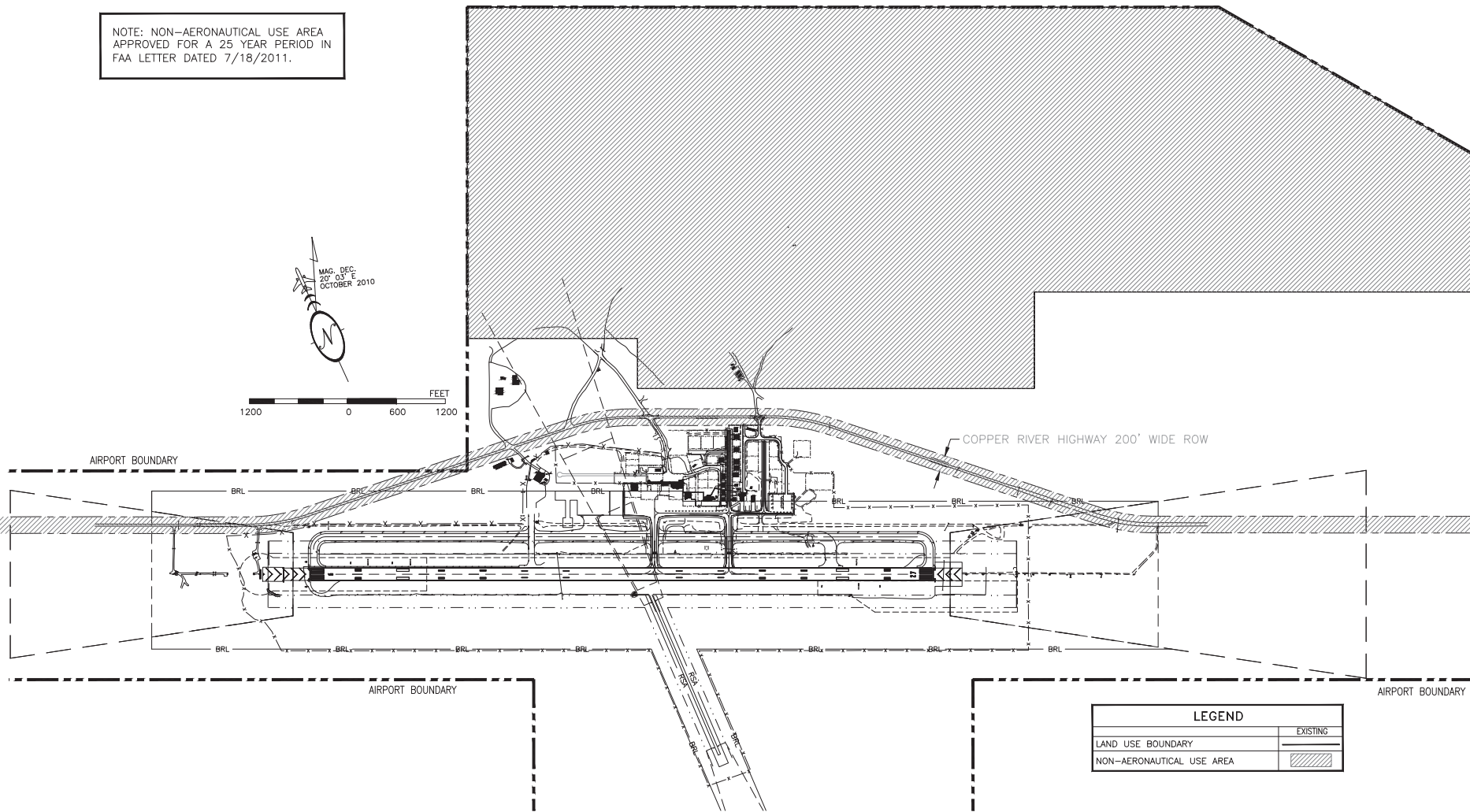

LEGEND	
LAND USE BOUNDARY	EXISTING
NON-AERONAUTICAL USE AREA	

DRAWING NAME: RN\Info_Corrections\Cordova\02_ALP_FHA_2019-11-21_11_14_Built\ALP_201700316-COV_ALP-AS-BUILT.dwg PLOTTED: Apr 02, 2020 - 2:23pm

DESIGN_ EUG, JGL		
DRAWN_ SMT		
CHECKED_ ZWS		
BY	DATE	REVISIONS
	10/02/18	AS-BUILT PROJECT
	5/1/09	AS-BUILT

STATE OF ALASKA
DEPARTMENT OF TRANSPORTATION AND PUBLIC FACILITIES
NORTHERN REGION

APPROVED
Albert Beck
ALBERT BECK, P.E.

DATE **4/17/2020**
PROJECT DELIVERY CHIEF

AIRPORT LAYOUT PLAN
APPROVED BY LETTER DATED: _____

AIRPORTS DIVISION,
ALASKAN REGION, AAL-601
AIRSPACE REVIEW #03AAL-166NRA

THIS ALP SUPERSEDES ALP SIGNED 05/15/12.
THIS ALP IS BASED ON THE 2006 PROJECT RECORD DRAWINGS: RUNWAY SAFETY AREA IMPROVEMENTS AND EMAS INSTALLATION PHASE I-61485, PHASE II-62788, AND 2016 PROJECT RECORD DRAWINGS: APRON TAXIWAY AND GA IMPROVEMENTS STAGE II - 61403

MERLE K. "MUDHOLE" SMITH AIRPORT
CORDOVA, ALASKA
LAND USE PLAN

SHEET
11 OF 11