



U.S. Department
of Transportation
**Federal Aviation
Administration**

Alaskan Region Airports Division

222 W. 7th Avenue, #14
Anchorage, Alaska 99513-7587
Tel. (907) 271-5438 / Fax (907) 271-2851

October 1, 2020

Phil Cheasebro
ADOT&PF Aviation Design
4111 Aviation Ave
Anchorage, AK 99519-6900

Dear Mr. Cheasebro:

**Chevak Airport
Chevak, Alaska
As-Built Airport Layout Plan (10 July 2020)
(Original ALP Airspace # 98AAL-006-NRA)**

We have completed our review of the Chevak Airport As-Built Airport Layout Plan (ALP) dated 10 July 2020, and find it acceptable for documenting the existing conditions of the airport.

Please retain this letter in your files for future reference.

Sincerely,

PATRICK J Digitally signed by
ZETTLER PATRICK J ZETTLER
Date: 2020.10.01
11:04:23 -08'00'
Pat Zettler, P.E., Lead Engineer
Airports Division

Date Plotted: 4/23/2015, 9:49 AM
 Layout Name: AIRPORT DATA
 File Name: W:\Projects\Chevak_VLP_2014\Final Drawings\Cover & Data.dwg
 Designed By: RRG
 Drawn By: RRG
 Checked By: JM/PC

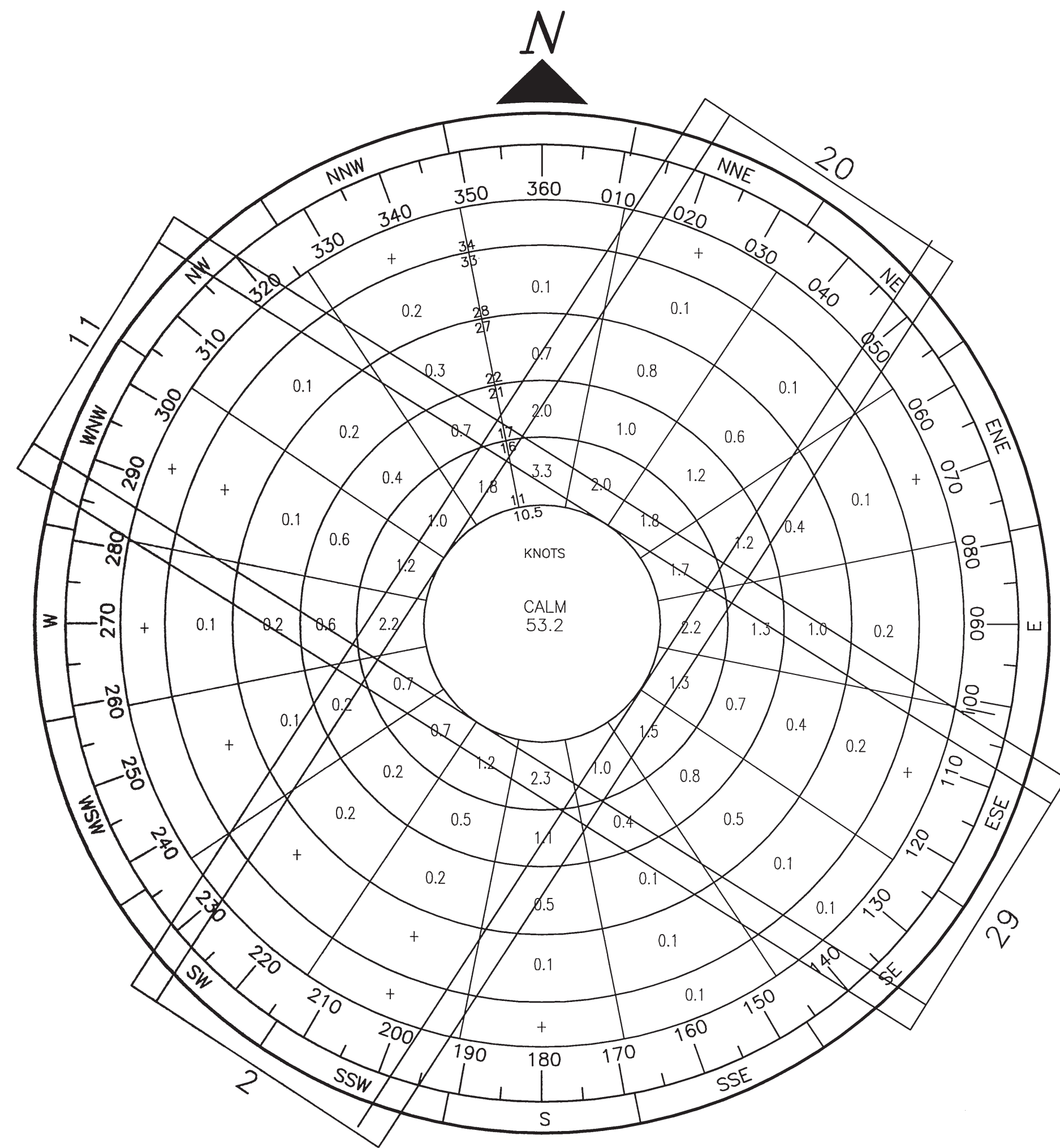

WIND DATA

WIND COVERAGE: 10.5 KNOT 13 KNOT

RUNWAY 2-20: 76.8% 86.1%

RUNWAY 11-29: 73.2% 83.2%

COMBINED: 92% 96.6%

CONDUCTED BY: ENRI, UAA-ALASKA CLIMATE CENTER

PERIOD: 7/31/95 TO 8/13/96

NONSTANDARD CONDITIONS			
ITEM	EXISTING	STANDARD	ULTIMATE
SEWAGE LAGOON SEPARATION	3,355	5,000	3,355
LANDFILL SEPARATION	4,078	5,000	4,078

AIRPORT DATA				
ITEM	EXISTING	ULTIMATE		
AIRPORT CODE	VAK			
FAA SITE NUMBER	50096.22*A			
AIRPORT ELEVATION (M.S.L.)	48.0'	48.5'		
AIRPORT REFERENCE POINT (A.R.P.) (NAD 83)	LAT.	N 61°32'27"	N 61°32'33"	
	LONG.	W 165°36'03"	W 165°36'07"	
MAGNETIC DECLINATION (DATE)	11°4'44"E (11/21/2014)			
TAXIWAY LIGHTING	MITL			
RAMP LIGHTING	FLOOD			
MEAN MAX. TEMPERATURE, HOTTEST MONTH (JULY)	14.9°C(58.8°F)		14.9°C(58.8°F)	
AIRPORT REFERENCE CODE	B-I			
AIRPORT AND TERMINAL NAVIGATION AIDS	B-I			
GEODETIC POSITIONS (NAD 83)				
	THRESHOLD 2	LAT.	N 61°32'13.83"	N 61°32'13.83"
		LONG.	W 165°36'21.20"	W 165°36'21.20"
	THRESHOLD 20	LAT.	N 61°32'40.25"	N 61°32'40.25"
		LONG.	W 165°35'45.22"	W 165°35'45.22"
	THRESHOLD 11	LAT.	N/A	N 61°32'46.50"
		LONG.	N/A	W 165°36'33.31"
	THRESHOLD 29	LAT.	N/A	N 61°32'33.08"
		LONG.	N/A	W 165°35'50.06"

NOTES:

1. THE GEODETIC COORDINATES WERE DEVELOPED FROM SURVEY TIES TO TRI. STATION CHEVAK. THE PUBLISHED COORDINATES FOR TRI. STATION CHEVAK ARE LAT. 61°31'26.128 N BY LONG. 165°36'07.778" W. THE ALASKA STATE PLANE GRID BEARING FOR RUNWAY 2-20 IS N 32°40'07" E.
2. HORIZONTAL SURVEY IS NAD83
VERTICAL SURVEY IS NAVD88

ITEM	RUNWAY 2/20		RUNWAY 11/29	
	EXISTING	ULTIMATE	EXISTING	ULTIMATE
EFFECTIVE GRADE	0.31%	0.31%	N/A	0.57%
% WIND COVERAGE	86.05	86.05		83.19
INSTRUMENT RUNWAY	NPI	NPI		NPI
RUNWAY SURFACE	GRAVEL	GRAVEL		GRAVEL
PAVEMENT STRENGTH (LBS.)	N/A	N/A		N/A
APPROACH SURFACES	34:1	34:1		34:1
VISIBILITY MINIMUM	>3/4 MI	>3/4 MI		>3/4 MI
RUNWAY LIGHTING	MIRL	MIRL		MIRL
RUNWAY MARKING	NONE	NONE		NONE
NAVIGATION AIDS	ROT. BEACON, GPS,PAPI,REIL	ROT. BEACON, GPS,PAPI,REIL		ROT. BEACON, GPS,REIL
RUNWAY SAFETY AREA DIMENSION	120 x 3680	120 x 3800	120 x 3800	120 x 3100
RUNWAY DIMENSION	75 x 3200	75 x 3200		60 x 2500
RUNWAY OBJECT FREE AREA DIMENSION	400 x 3800	400 x 3800		400 x 3100
RUNWAY OBSTACLE FREE ZONE DIMENSION	400 x 3600	400 x 3600	N/A	400 x 2900

STATE OF ALASKA DEPARTMENT OF TRANSPORTATION AND PUBLIC FACILITIES CENTRAL REGION		DATE: 4/23/2015
CHEVAK AIRPORT CHEVAK, ALASKA AIRPORT LAYOUT PLAN		SHEET: 2 OF 12
BY	DATE	REVISION
		7/10/2020 AS-BUILT PER 56626 AND METRIC TO ENGLISH CONVERSION

BUILDING DATA TABLE				
ID	DESCRIPTION	STATION/OFFSET	TOP ELEVATION	OBSTRUCTION MARKING
1	SREB	12+24 683R	56.8	NONE
2	SREB	11+75 683R	56.8	NONE
3	FAA WEATHER STATION	9+94 603R	66.8	NONE

*STATION/OFFSET MEASURED AT THE CENTER OF THE BUILDING EDGE CLOSEST TO THE RUNWAY

NOTES

1. NO THRESHOLD SITING SURFACE OBJECT PENETRATIONS.
2. THE BRL FOLLOWS THE PROPERTY LINE EXCEPT AS SHOWN.
3. 3-1/2" USC&GS BRASS CAP ON 1-1/4" COPPER PIPE MONUMENT WITH DESCRIPTION TRI STA CHEVAK 1951 IS LOCATED 4953.8', S07°22'40.7"E FROM RW 02/20 STA 10+00.

Designed By: RKB
 Drawn By: RKB
 Checked By: JW/PC
 Date Plotted: 4/23/2015, 8:42 AM
 Layout Name: EXISTING LAYOUT
 File Name: M:\Projects\Chevak\ALP 2014\Final Drawings\EXISTING LAYOUT.dwg

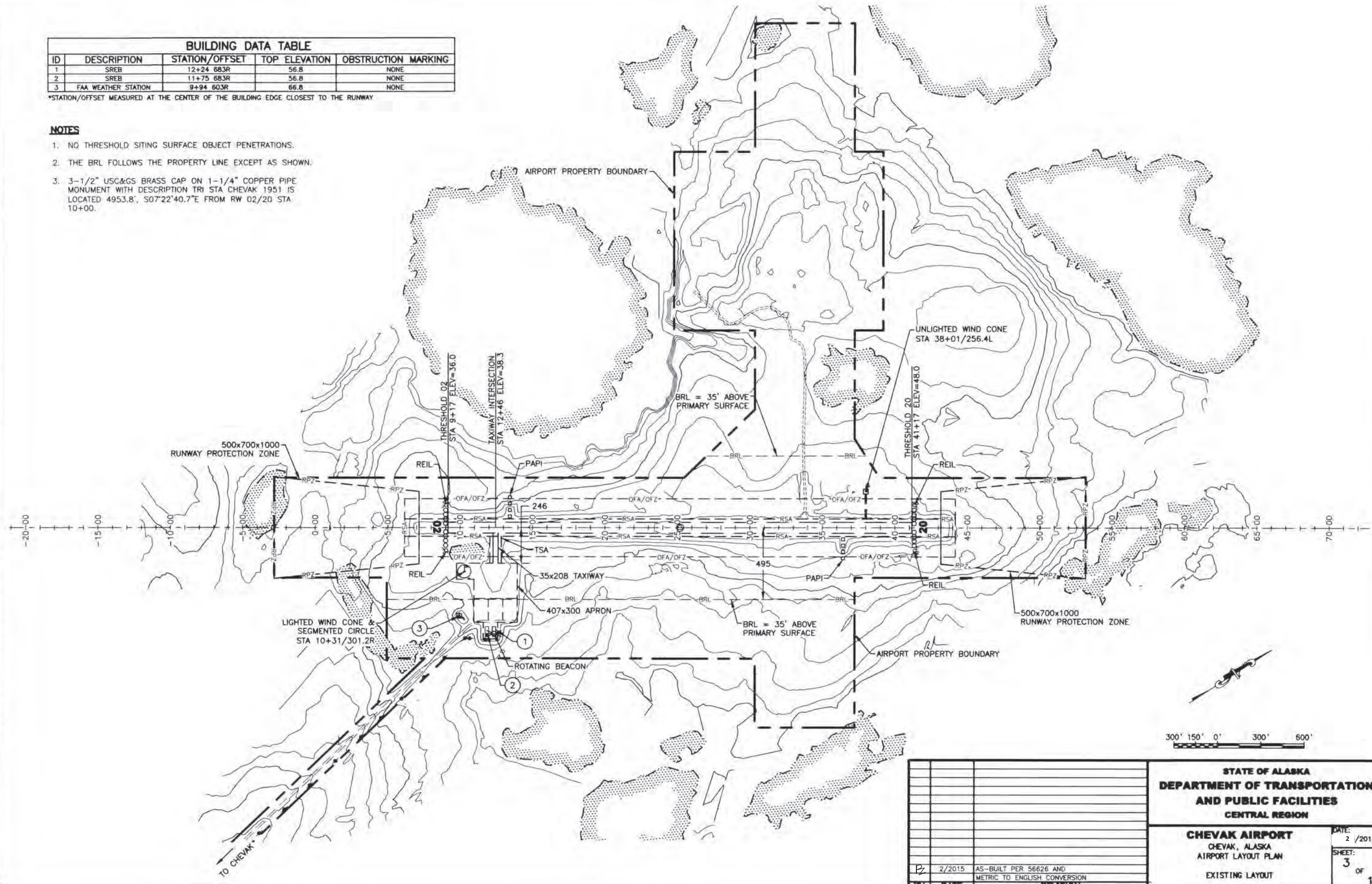

BY	DATE	REVISION

STATE OF ALASKA
 DEPARTMENT OF TRANSPORTATION
 AND PUBLIC FACILITIES
 CENTRAL REGION

CHEVAK AIRPORT
 CHEVAK, ALASKA
 AIRPORT LAYOUT PLAN
 EXISTING LAYOUT

DATE: 2 / 2015
 SHEET: 3 OF 12

2/2015 AS-BUILT PER 56626 AND METRIC TO ENGLISH CONVERSION

BUILDING DATA TABLE				
ID	DESCRIPTION	STATION/OFFSET	TOP ELEVATION	OBSTRUCTION MARKING
1	SREB	12+24 68.3R	56.8	NONE
2	SREB	11+75 68.3R	56.8	NONE
3	FAA WEATHER STATION	9+94 60.3R	66.8	NONE

*STATION/OFFSET MEASURED AT THE CENTER OF THE BUILDING EDGE CLOSEST TO THE RUNWAY

NOTES

1. NO THRESHOLD SITING SURFACE OBJECT PENETRATIONS.
2. NO OBJECT FREE ZONE PENETRATIONS.
3. THE BRL FOLLOWS THE PROPERTY LINE EXCEPT AS SHOWN.
4. 3-1/2" USC&GS BRASS CAP ON 1-1/4" COPPER PIPE MONUMENT WITH DESCRIPTION TRI STA CHEVAK 1951 IS LOCATED 4953.8', S07°22'40.7"E FROM RW 02/20 STA 10+00.

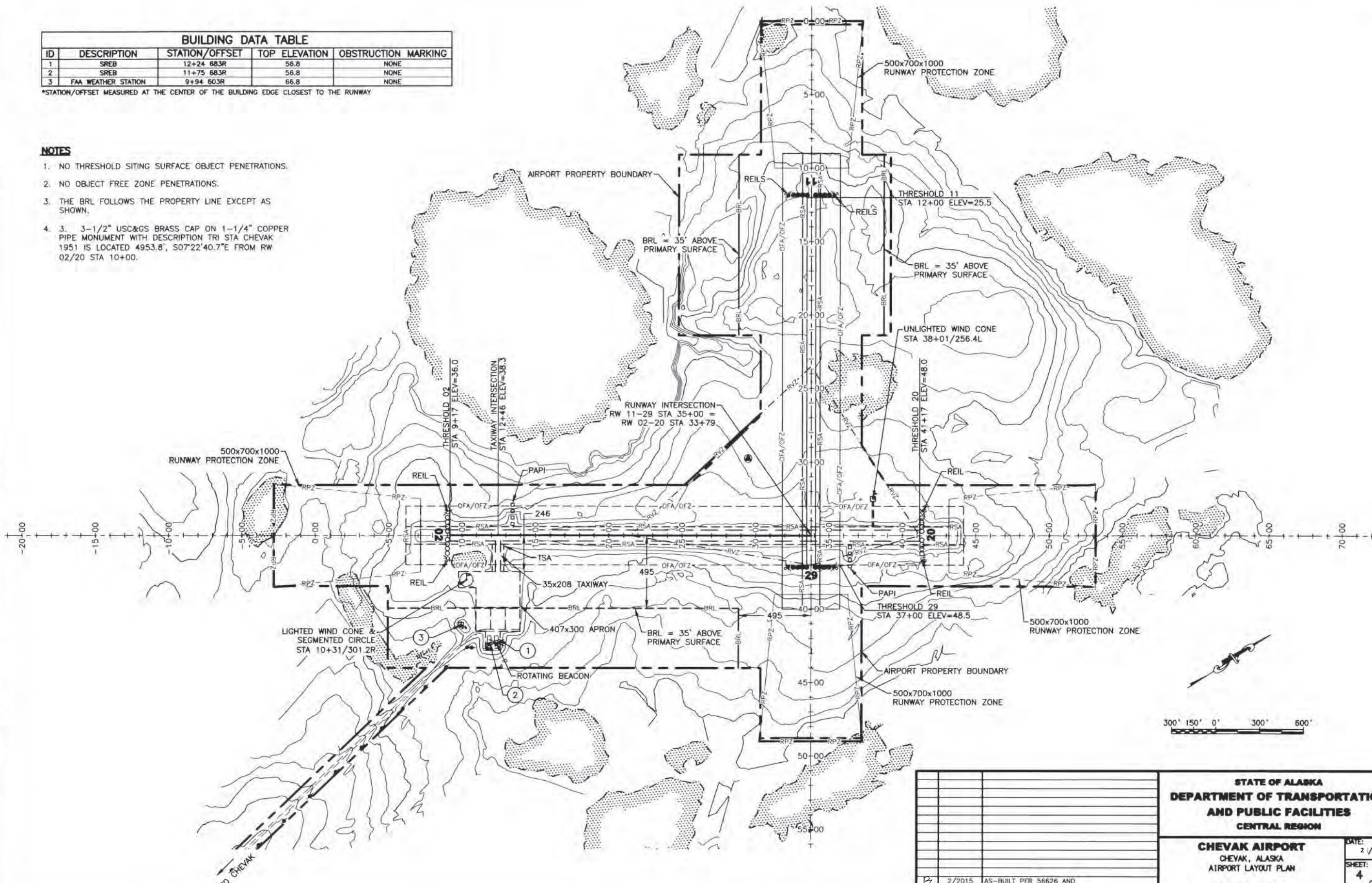

Date Plotted: 4/23/2015, 8:42 AM
 Layout Name: ULTIMATE LAYOUT
 Plot Name:

STATE OF ALASKA DEPARTMENT OF TRANSPORTATION AND PUBLIC FACILITIES CENTRAL REGION	
CHEVAK AIRPORT CHEVAK, ALASKA AIRPORT LAYOUT PLAN ULTIMATE LAYOUT	
BY: DATE:	AS-BUILT PER 56626 AND METRIC TO ENGLISH CONVERSION REVISION
DATE: 2 / 2015 SHEET: 4 OF 12	

Date Plotted: 4/27/2015, 8:03 AM
 Plot Name: HAZZ APPROACH 02
 Plot Source: W:\Projects\Chevok_MLP_2014\Final_Drawings\Azimuthal_Profile_and_Profile.plt
 Designer By: RSB
 Check By: M/PS

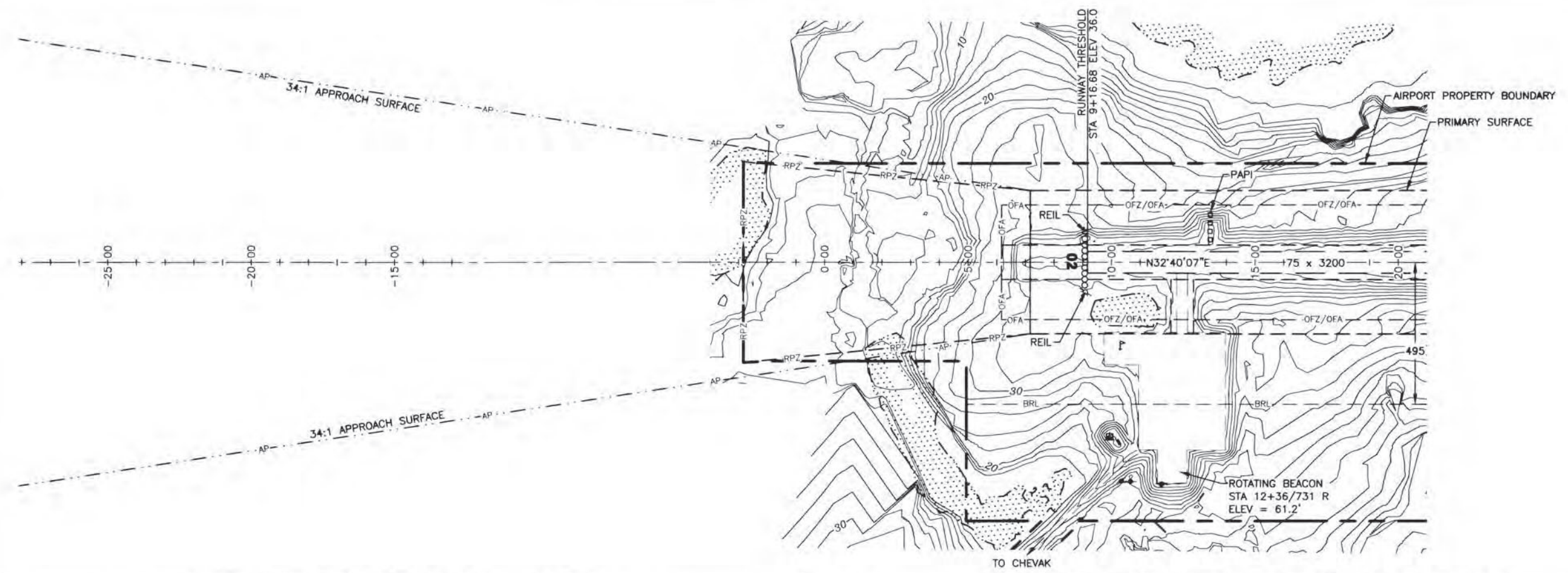

34:1 DEPARTURE SURFACE PENETRATIONS (RW 02)

OBSTRUCTION ID	DESCRIPTION	OBSTRUCTION DIST/OFFSET	OBSTRUCTION ELEVATION	SURFACE PENETRATED	SURFACE ELEVATION	AMOUNT OF PENETRATION	DISPOSITION	STAGE TO BE CORRECTED
	NONE							

PART 77 SURFACE OBSTRUCTION (INNER PORTION RW 02)

OBSTRUCTION ID	DESCRIPTION	OBSTRUCTION DIST/OFFSET	OBSTRUCTION ELEVATION	SURFACE PENETRATED	SURFACE ELEVATION	AMOUNT OF PENETRATION	DISPOSITION	STAGE TO BE CORRECTED
	NONE							

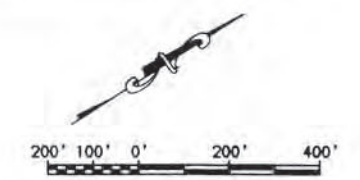
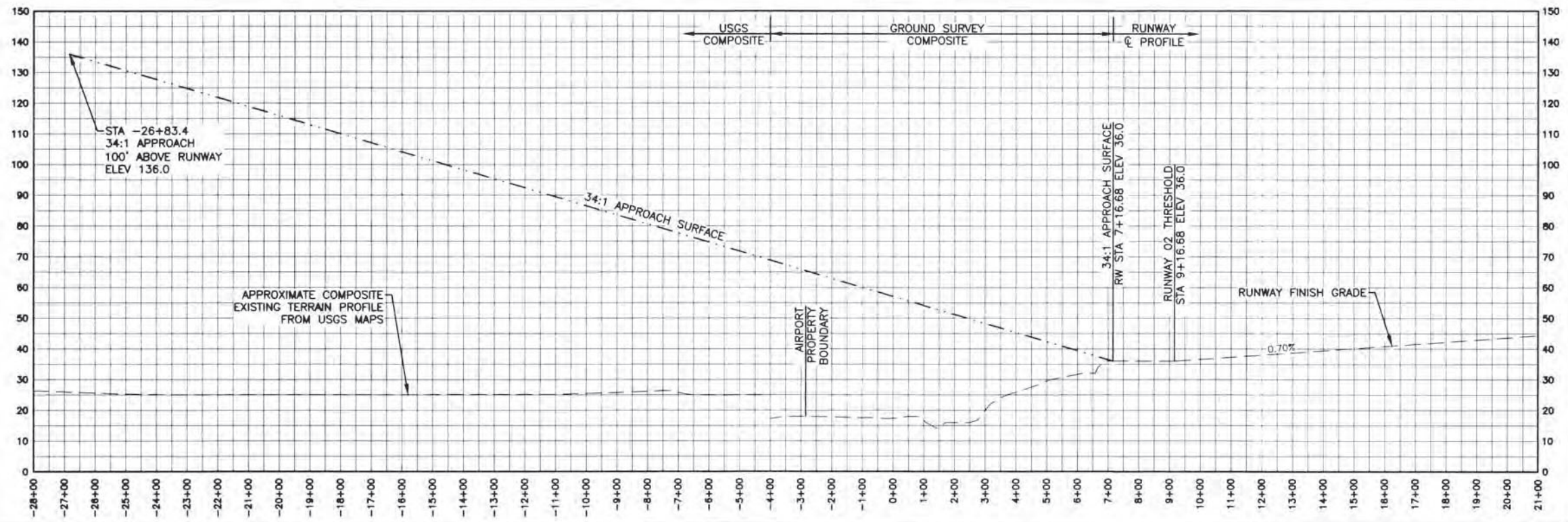

STATE OF ALASKA DEPARTMENT OF TRANSPORTATION AND PUBLIC FACILITIES CENTRAL REGION											
		2/2015 AS-BUILT PER 56626 AND METRIC TO ENGLISH CONVERSION REVISION									
CHEVAK AIRPORT CHEVAK, ALASKA AIRPORT LAYOUT PLAN EXISTING INNER PORTION OF THE APPROACH SURFACE - RUNWAY 2											
										DATE:	2 / 2015
										SHEET:	5 OF 12

Date Plotted: 4/23/2015 9:07 AM
 Layout Name: ILMX APPROACH RW20
 File Name: I:\Projects\CentralADP_2014\17\del_bromo\Existing Plans and Profiles.dwg
 Drawn By: JRP/PC
 Checked By: JRP/PC

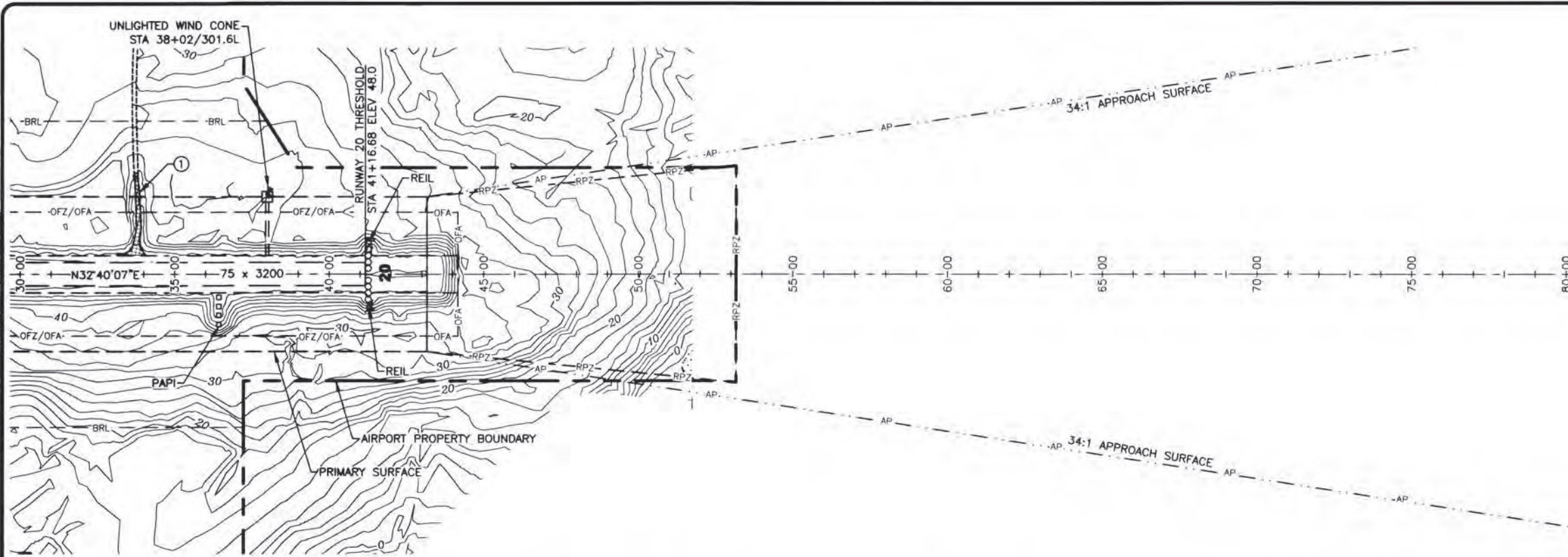

34:1 DEPARTURE SURFACE PENETRATIONS (RW 20)								
OBSTRUCTION ID	DESCRIPTION	OBSTRUCTION DIST/OFFSET	OBSTRUCTION ELEVATION	SURFACE PENETRATED	SURFACE ELEVATION	AMOUNT OF PENETRATION	DISPOSITION	STAGE TO BE CORRECTED
	NONE							

PART 77 SURFACE OBSTRUCTION (INNER PORTION RW 20)								
OBSTRUCTION ID	DESCRIPTION	OBSTRUCTION DIST/OFFSET	OBSTRUCTION ELEVATION	SURFACE PENETRATED	SURFACE ELEVATION	AMOUNT OF PENETRATION	DISPOSITION	STAGE TO BE CORRECTED
1	ROAD+15	62.0/33+10 317.5/34+06	63.0	TRANSITIONAL/ PRIMARY/ OFA/OFA	48.0	15.0	TO BE REMOVED	ULTIMATE

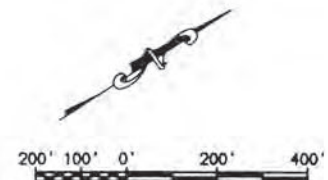
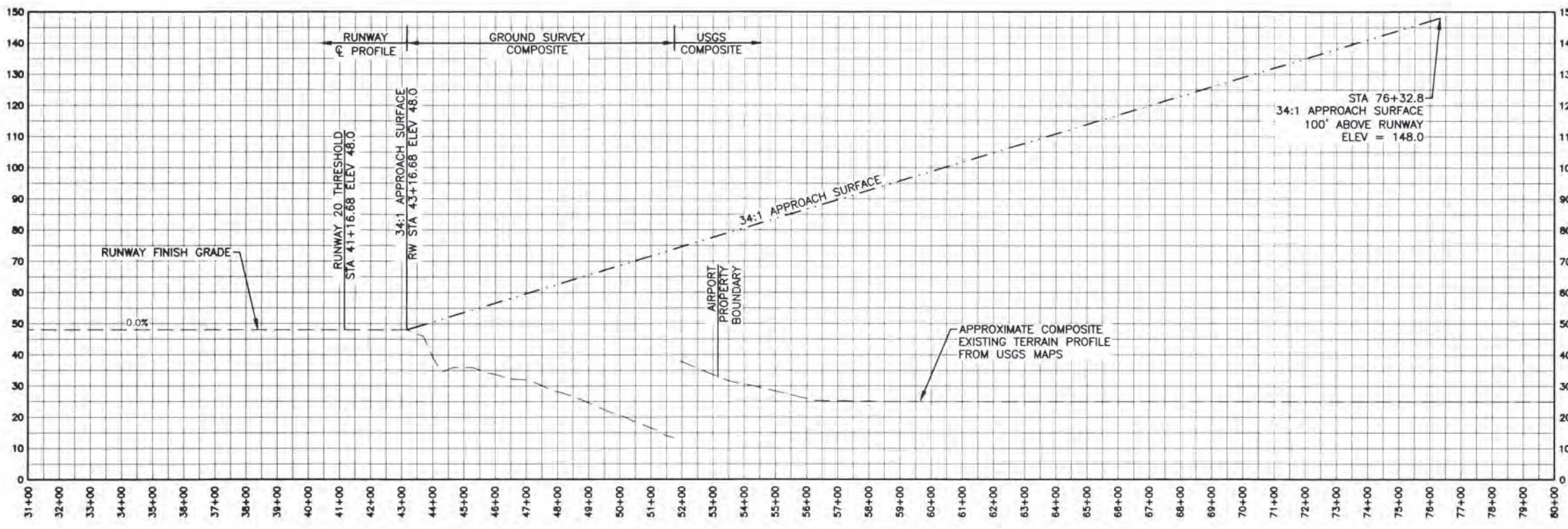

BY	DATE	REVISION
PZ	2/2015	AS-BUILT PER 56626 AND METRIC TO ENGLISH CONVERSION
STATE OF ALASKA DEPARTMENT OF TRANSPORTATION AND PUBLIC FACILITIES CENTRAL REGION		
CHEVAK AIRPORT CHEVAK, ALASKA AIRPORT LAYOUT PLAN EXISTING INNER PORTION OF THE APPROACH SURFACE - RUNWAY 20		DATE: 2 / 2015 SHEET: 6 OF 12

Date Plotted: 4/23/2015, 9:05 AM
 Airport Name: CHEYAK AIRPORT
 File Name: W:\Projects\G111\Drawings\ALP 2014\11-29-2014\11-29-2014-Runway and Profile.dwg

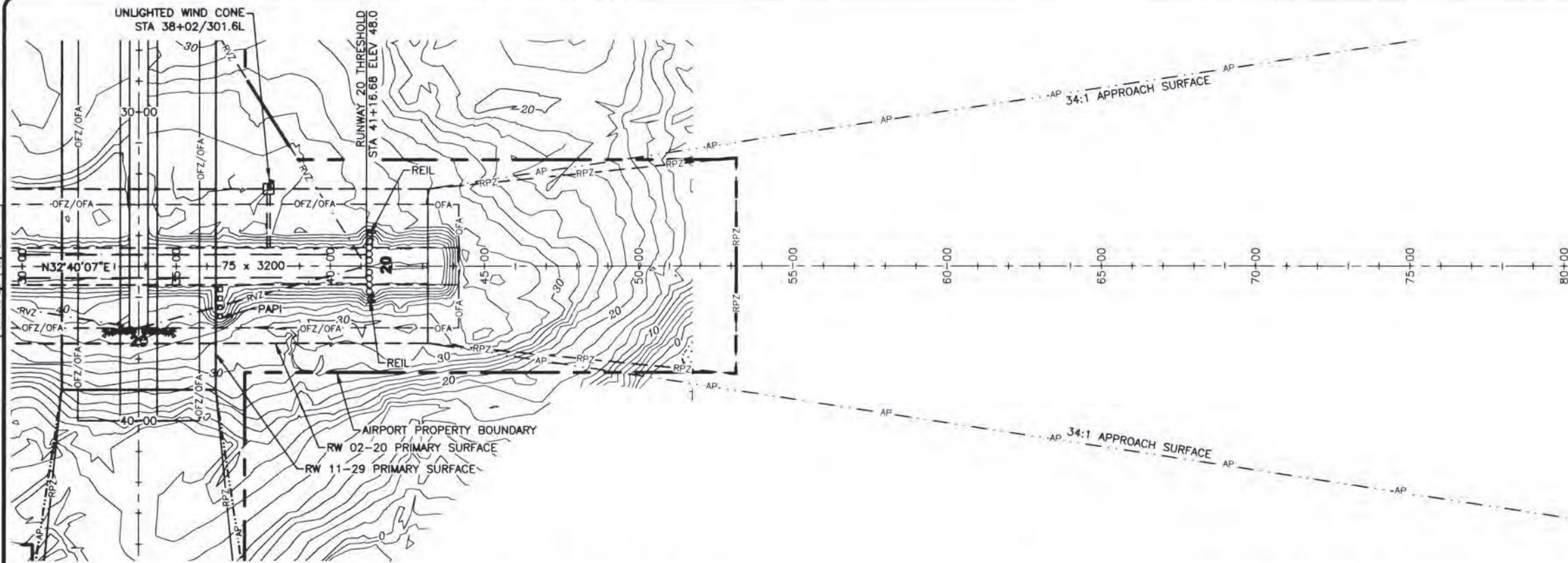

34:1 DEPARTURE SURFACE PENETRATIONS (RW 20)								
OBSTRUCTION ID	DESCRIPTION	OBSTRUCTION DIST/OFFSET	OBSTRUCTION ELEVATION	SURFACE PENETRATED	SURFACE ELEVATION	AMOUNT OF PENETRATION	DISPOSITION	STAGE TO BE CORRECTED
	NONE							

PART 77 SURFACE OBSTRUCTION (INNER PORTION RW 20)								
OBSTRUCTION ID	DESCRIPTION	OBSTRUCTION DIST/OFFSET	OBSTRUCTION ELEVATION	SURFACE PENETRATED	SURFACE ELEVATION	AMOUNT OF PENETRATION	DISPOSITION	STAGE TO BE CORRECTED
	NONE							

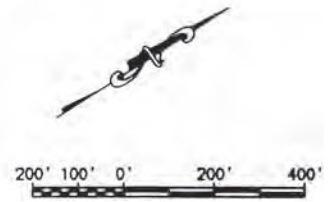
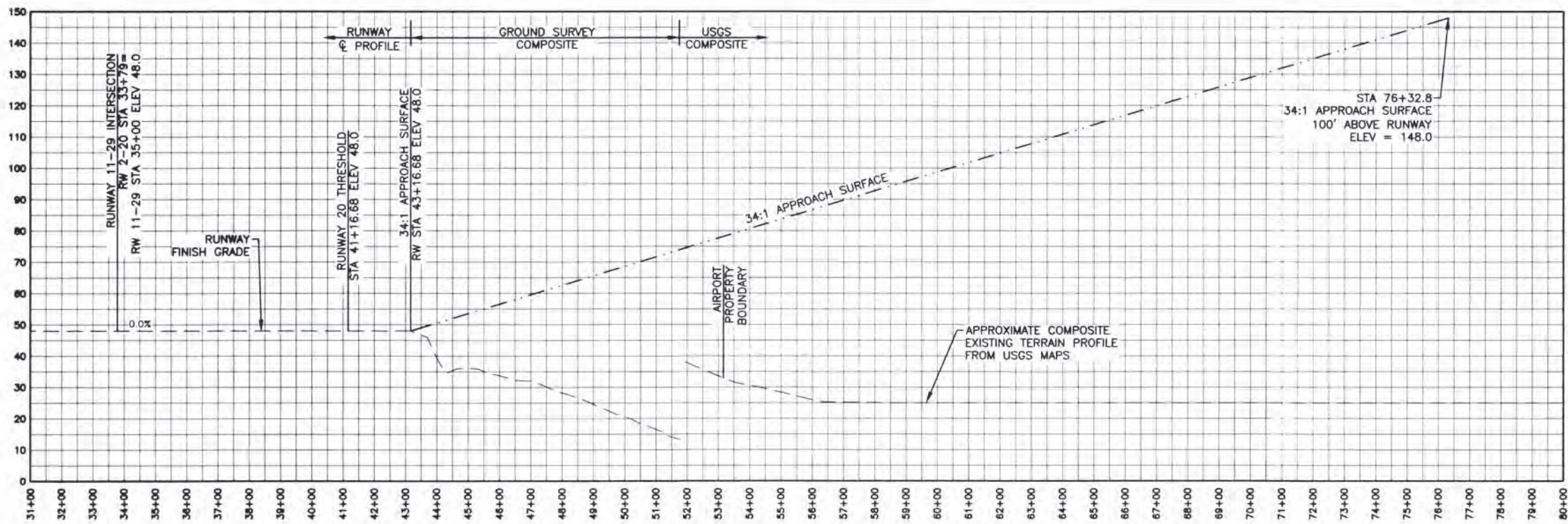

BY	DATE								REVISION
STATE OF ALASKA DEPARTMENT OF TRANSPORTATION AND PUBLIC FACILITIES CENTRAL REGION									
CHEYAK AIRPORT CHEYAK, ALASKA AIRPORT LAYOUT PLAN ULTIMATE INNER PORTION OF THE APPROACH SURFACE - RUNWAY 20								DATE: 2 / 2015	
SHEET: 8 OF 12									

Date Plotted: 4/23/2015, 9:06 AM
 Layout Name: 11-AP-11
 File Name: \\projects\chevak\AP-2015\11-AP-11-28-Plans-and-Profile.dwg
 Drawn By: JH/PC
 Checked By: JH/PC

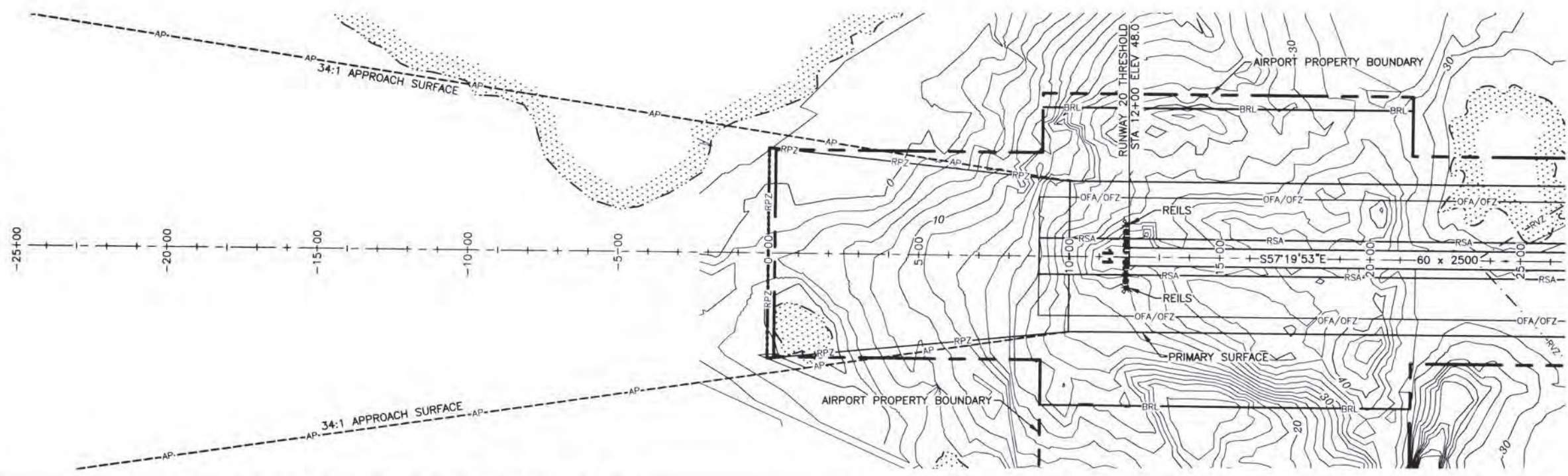

34:1 DEPARTURE SURFACE PENETRATIONS (RW 11)

OBSTRUCTION ID	DESCRIPTION	OBSTRUCTION DIST/OFFSET	OBSTRUCTION ELEVATION	SURFACE PENETRATED	SURFACE ELEVATION	AMOUNT OF PENETRATION	DISPOSITION	STAGE TO BE CORRECTED
	NONE							

PART 77 SURFACE OBSTRUCTION (INNER PORTION RW 11)

OBSTRUCTION	DESCRIPTION	OBSTRUCTION DIST/OFFSET	OBSTRUCTION ELEVATION	SURFACE PENETRATED	SURFACE ELEVATION	AMOUNT OF PENETRATION	DISPOSITION	STAGE TO BE CORRECTED
	NONE							

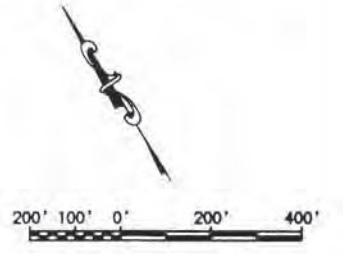
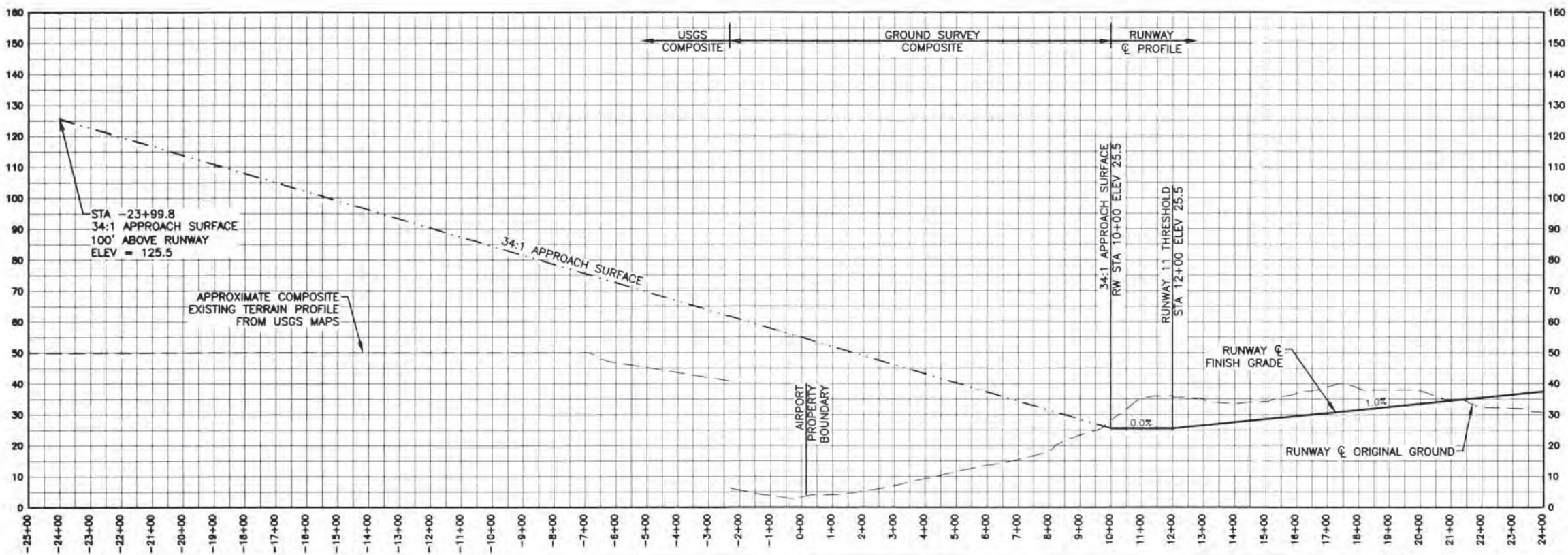

NO.	DATE	REVISION

2/2015 AS-BUILT PER 56626 AND METRIC TO ENGLISH CONVERSION
 BY DATE REVISION

STATE OF ALASKA
DEPARTMENT OF TRANSPORTATION AND PUBLIC FACILITIES
CENTRAL REGION

CHEVAK AIRPORT
 CHEVAK, ALASKA
 AIRPORT LAYOUT PLAN
 ULTIMATE INNER PORTION OF THE APPROACH SURFACE - RUNWAY 11

DATE: 2/2015
 SHEET: 9 of 12

Designed By: RCB
 Drawn By: JWP/PC
 Checked By:

Date Plotted: 4/23/2015 9:07 AM
 Layout Name: 11-29 Run 29
 File Name: I:\Projects\Oroville\2014\11-29 Run 29 Plans and Profiles.dwg

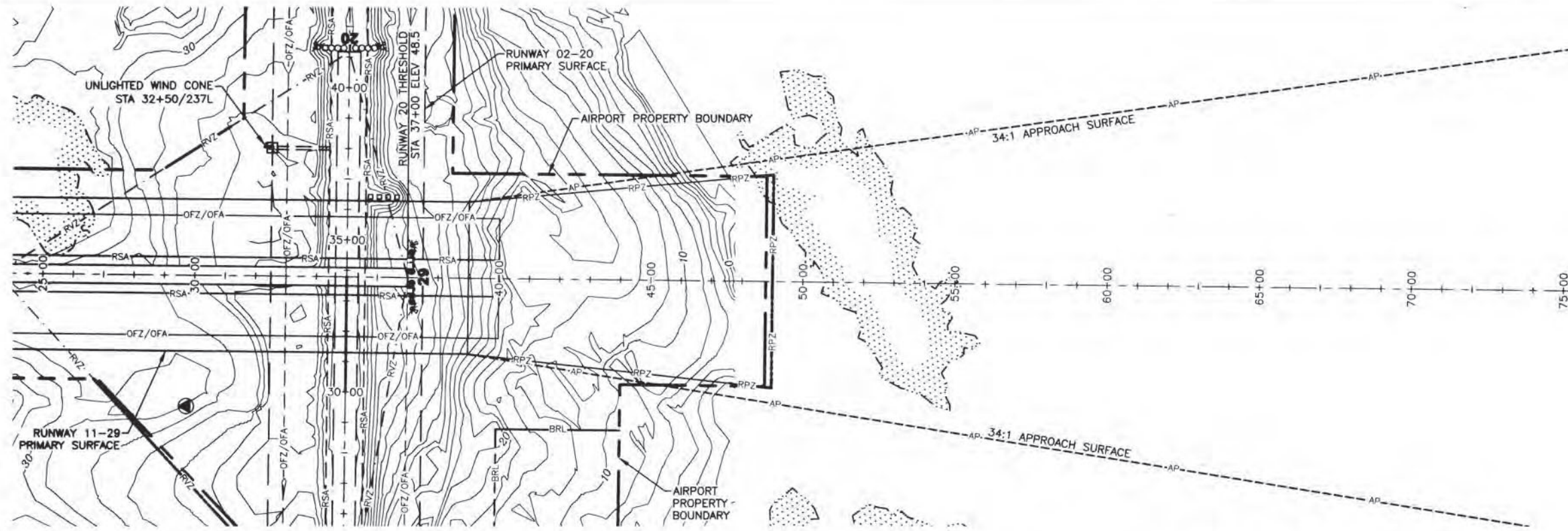

34:1 DEPARTURE SURFACE PENETRATIONS (RW 29)

OBSTRUCTION ID	DESCRIPTION	OBSTRUCTION DIST/OFFSET	OBSTRUCTION ELEVATION	SURFACE PENETRATED	SURFACE ELEVATION	AMOUNT OF PENETRATION	DISPOSITION	STAGE TO BE CORRECTED
	NONE							

PART 77 SURFACE OBSTRUCTION (INNER PORTION RW 29)

OBSTRUCTION ID	DESCRIPTION	OBSTRUCTION DIST/OFFSET	OBSTRUCTION ELEVATION	SURFACE PENETRATED	SURFACE ELEVATION	AMOUNT OF PENETRATION	DISPOSITION	STAGE TO BE CORRECTED
	NONE							

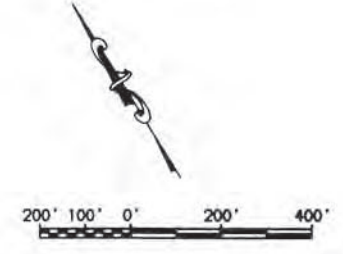
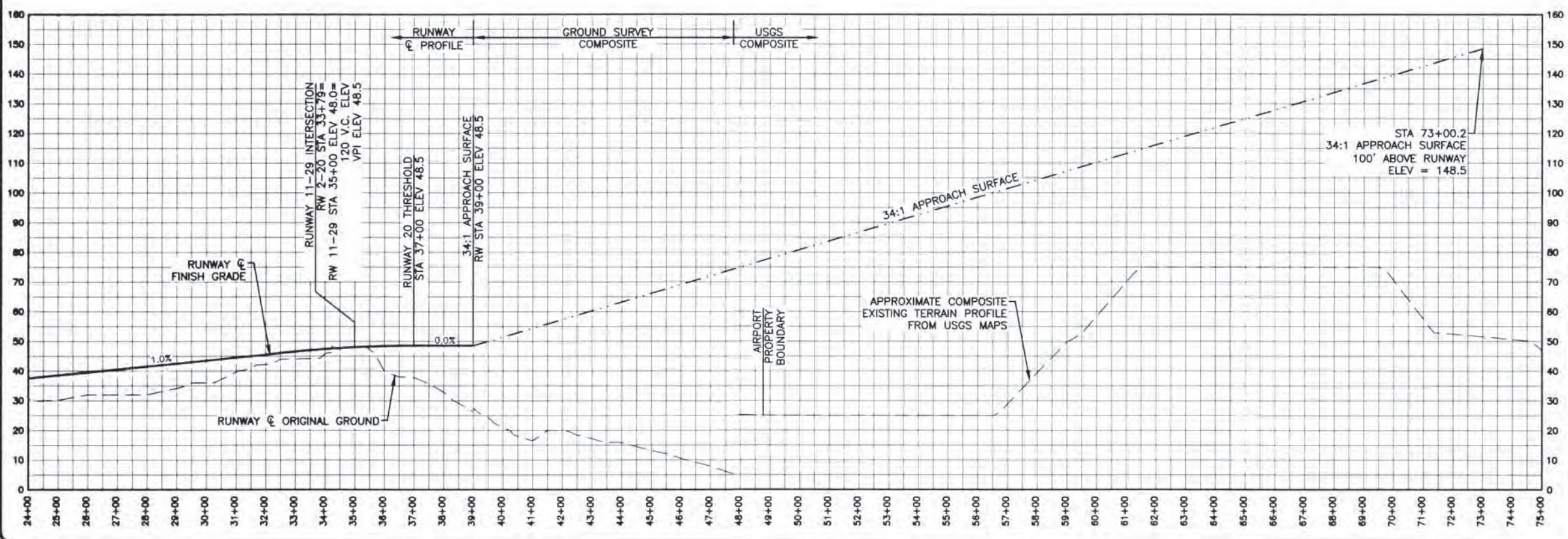

BY	DATE	REVISION
	2/2015	AS-BUILT PER 56626 AND METRIC TO ENGLISH CONVERSION
STATE OF ALASKA DEPARTMENT OF TRANSPORTATION AND PUBLIC FACILITIES CENTRAL REGION		
CHEVAK AIRPORT CHEVAK, ALASKA AIRPORT LAYOUT PLAN ULTIMATE INNER PORTION OF THE APPROACH SURFACE - RUNWAY 29		DATE: 2 / 2015 SHEET: 10 OF 12

Date Plotted: 1/23/2015, 9:08 AM
 Layout Name: PART 77
 File Name: W:\Projects\Chevak VAP 2014\14-17 N\Drawings\Part 77.dwg

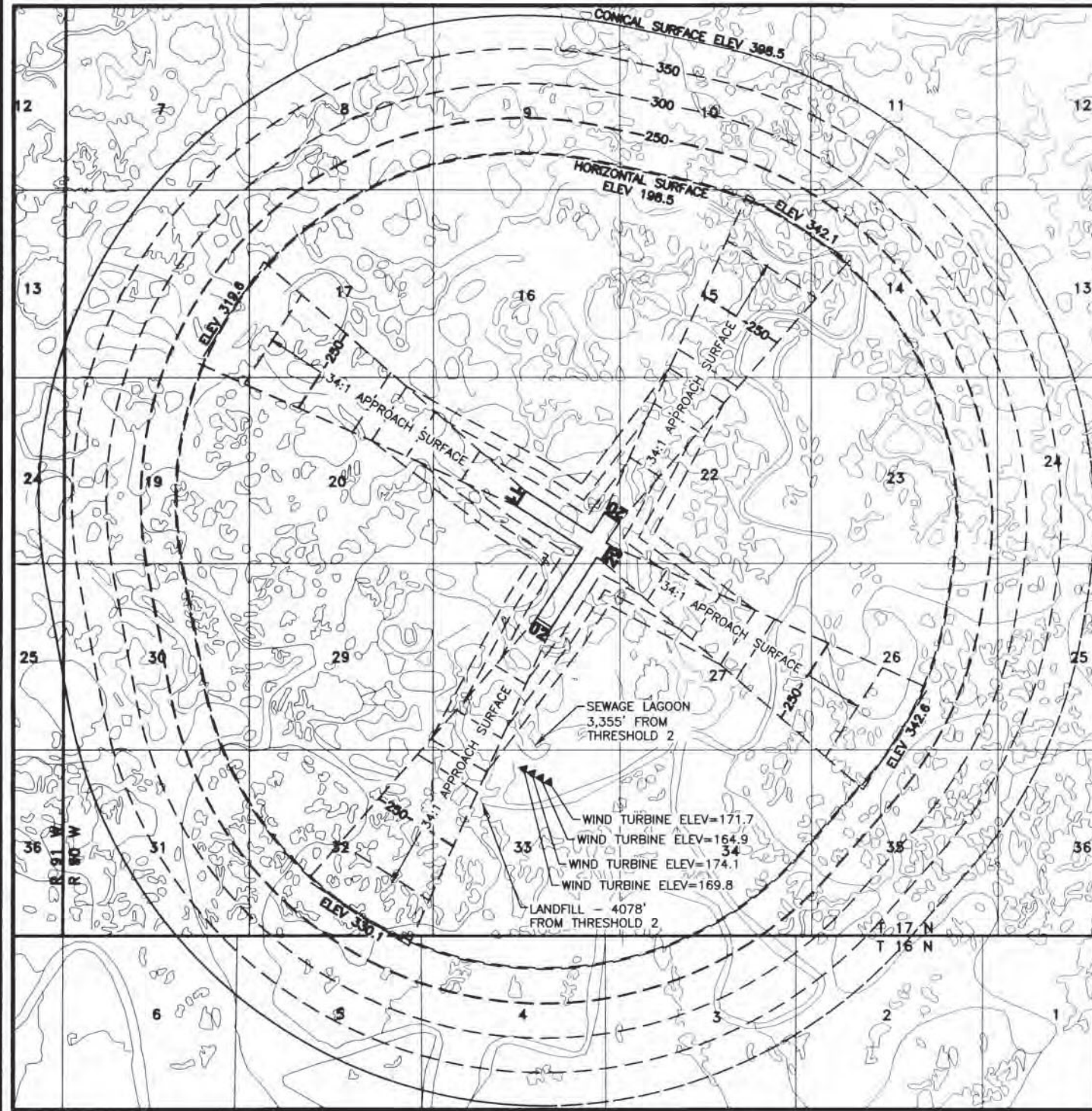

NOTES:

1. ULTIMATE AIRPORT ELEVATION IS 48.5' (NAVD88)
2. APPROACH SURFACES ARE NPI BEGINNING AT THE THRESHOLDS.
3. BASE MAP DATA FROM USSG QUADS HOOPER BAY C-2, ALASKA
4. REFER TO THE INNER PORTION OF THE APPROACH SURFACE SHEETS FOR CLOSE IN OBSTRUCTIONS.
5. PRIMARY SURFACE WIDTH IS 500 FEET.
6. NO KNOWN HEIGHT OBSTRUCTIONS.



F.A.R. PART 77 IMAGINARY SURFACE OBSTRUCTION TABLE

OBSTRUCTION ID	DESCRIPTION	OBSTRUCTION DIST/OFFSET	OBSTRUCTION ELEVATION	SURFACE PENETRATED	SURFACE ELEVATION	AMOUNT OF PENETRATION	DISPOSITION	STAGE TO BE CORRECTED
	NONE							

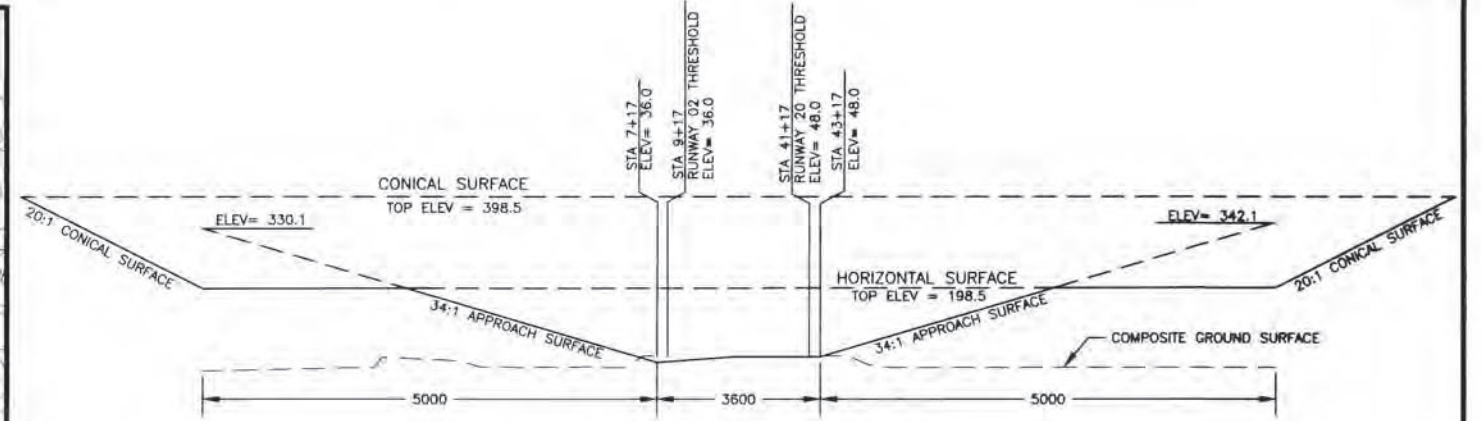

RUNWAY 02-20 PROFILE

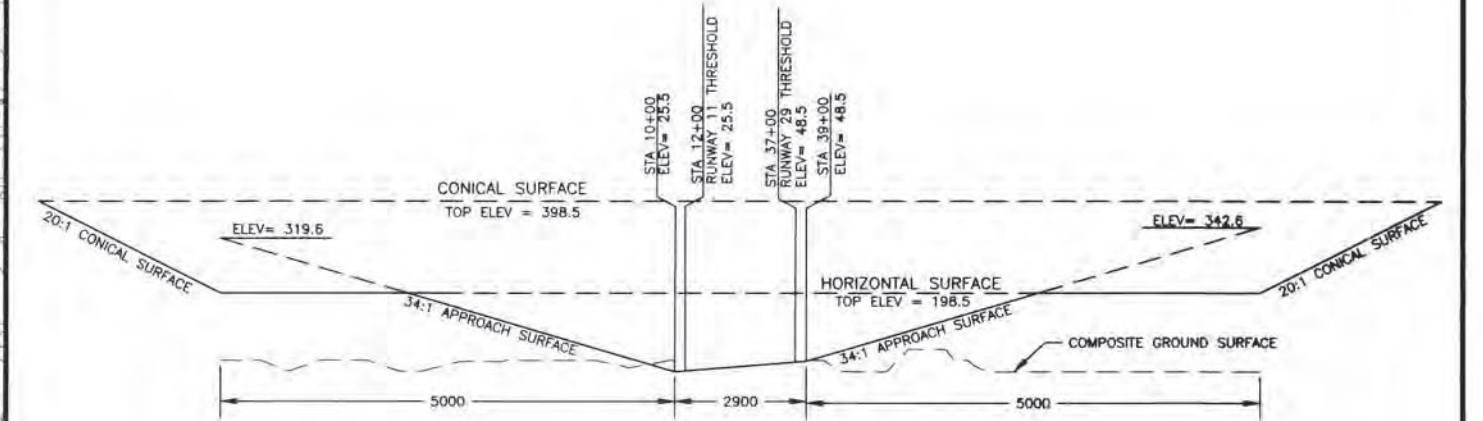

RUNWAY 11-29 PROFILE



BY	DATE	REVISION
PZ	2/2015	AS-BUILT PER 56626 AND METRIC TO ENGLISH CONVERSION

STATE OF ALASKA
 DEPARTMENT OF TRANSPORTATION
 AND PUBLIC FACILITIES
 CENTRAL REGION

CHEVAK AIRPORT
 CHEVAK, ALASKA
 AIRPORT LAYOUT PLAN
 AIRPORT AIRSPACE, 14 CFR, PART 77

DATE: 2/2015
 SHEET: 11 OF 12

PROPERTY STATUS									
PARCEL NO.	INTEREST TO BE ACQUIRED	GRANTOR	GRANTEE	LARGER PARCEL AREA	NET TAKE	REMAIN	RECORDED DOCUMENT NUMBER	RECORDED DOCUMENT DATE	ACQUIRED UNDER AIP NO.
1	FEE / SURFACE (INCORRECT)	CHEVAK COMPANY	STATE OF ALASKA, DOT/PF	LARGE	194.93 AC (78.888 Ha) (INCORRECT)	LARGE	1999-000042-0 (INCORRECT)	01/07/1999	3-02-0052-01
	FEE / SURFACE (CORRECTED)	CHEVAK COMPANY		LARGE	189.48 AC (CORRECTED)		2015-000994-0 (CORRECTED)	10/05/2015	3-02-0468-001-2005
	SUBSURFACE	UNITED STATES OF AMERICA/USFWS		LARGE	189.48 AC		SUBSURFACE NOT ACQUIRED		
1A	FEE / SURFACE	CHEVAK COMPANY	STATE OF ALASKA, DOT/PF	LARGE	13,386 S.F.	LARGE	2015-000992-0	10/05/2015	3-02-0468-001-2005
	SUBSURFACE	UNITED STATES OF AMERICA/USFWS					SUBSURFACE NOT ACQUIRED		
2	FEE / SURFACE (INCORRECT)	CHEVAK COMPANY	STATE OF ALASKA, DOT/PF	652.6 AC USS 12825	19.50 AC (7.892 Ha) (INCORRECT)	LARGE	1999-000041-0 (INCORRECT)	01/07/1999	3-02-0052-01
	FEE / SURFACE (CORRECTED)	CHEVAK COMPANY			24.95 AC (CORRECTED)		2015-000995-0 (CORRECTED)	10/05/2015	3-02-0468-001-2005
	FEE / SUBSURFACE *	CALISTA CORP.			19.50 AC (7.892 Ha)		1999-000040-0	01/07/1999	3-02-0052-01
2A	FEE / SURFACE	CHEVAK COMPANY	STATE OF ALASKA, DOT/PF	652.6 AC USS 12825	67,624 S.F.	LARGE	2015-000990-0	10/05/2015	3-02-0468-001-2005
	FEE / SUBSURFACE	CALISTA CORP.			67,624 S.F.		2015-000991-0	10/05/2015	3-02-0468-001-2005
2B	FEE / SUBSURFACE *	CALISTA CORP.		652.6 AC USS 12825	5.449 AC	LARGE	2015-000690-0	10/05/2015	3-02-0468-001-2005
3	FEE / SURFACE	CHEVAK COMPANY	STATE OF ALASKA, DOT/PF	86.74 AC	9,599 S.F.	LARGE	1983-000355-0 & 2009-000553-0	04/30/2009	3-02-0468-001-2005
	SUBSURFACE	UNITED STATES OF AMERICA/USFWS					SUBSURFACE NOT ACQUIRED		
4	FEE / SURFACE	CHEVAK COMPANY	STATE OF ALASKA, DOT/PF	LARGE	3,229 S.F.	LARGE	2015-000993-0	10/05/2015	3-02-0468-001-2005
	SUBSURFACE	UNITED STATES OF AMERICA/USFWS					SUBSURFACE NOT ACQUIRED		
5	FEE / SURFACE	CHEVAK COMPANY	STATE OF ALASKA, DOT/PF		0.36 AC		TO BE ACQUIRED	TO BE ACQUIRED	TO BE ACQUIRED
6	FEE / SURFACE	CHEVAK COMPANY	STATE OF ALASKA, DOT/PF		0.36 AC		TO BE ACQUIRED	TO BE ACQUIRED	TO BE ACQUIRED
7	FEE / SURFACE	CHEVAK COMPANY	STATE OF ALASKA, DOT/PF		0.23 AC		TO BE ACQUIRED	TO BE ACQUIRED	TO BE ACQUIRED

NOTES:

- BETHEL RECORDING DISTRICT
- IN 2012, IT WAS DISCOVERED THAT THE 1999 RECORDED NORTH BOUNDARY OF PARCEL 2, SUBSURFACE: BK 82 PG 431-435, SURFACE : BK 82 PG 436-441, DID NOT COINCIDE WITH THE CHEVAK CITY LIMITS FIELD SURVEY AS REFLECTED IN THE RECORD OF SURVEY PLAT 2012-32. EXHIBIT A OF THE AIRPORT PROPERTY PLAN ADDS THE CORRECTED SUBSURFACE DIMENSIONS AS DEPICTED BY PARCEL 2B. THE SURFACE TO PARCEL 2B WILL BE INCLUDED WITHIN THE CORRECT PARCEL 2, AND WAS INCLUDED WITHIN THE PREVIOUS INCORRECT PARCELS 1 & 2.

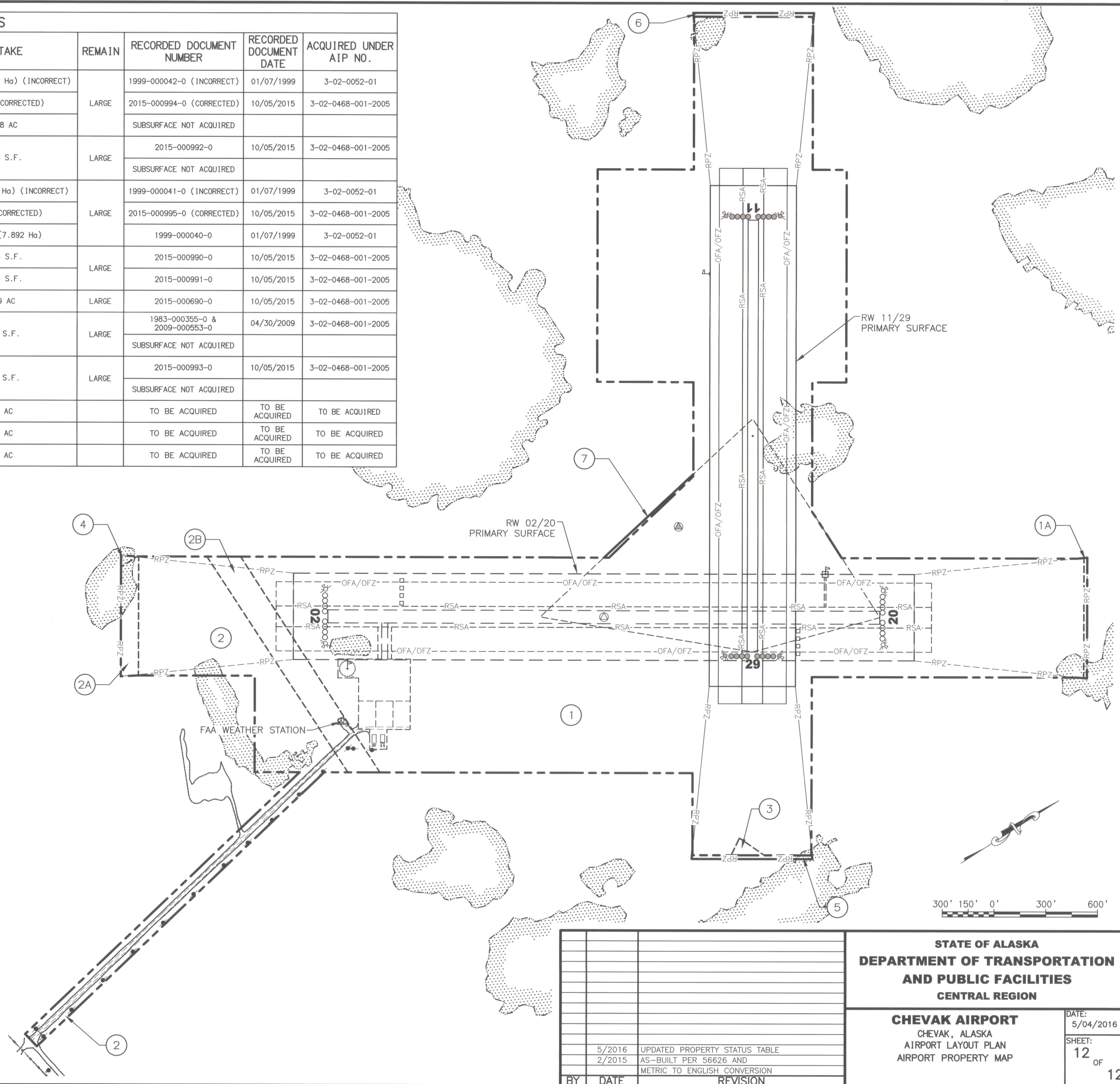

Date Plotted: 5/04/2016, 8:54 AM
 Property:
 Layout Name: W:\Projects\Chevak\ALP\Chevak_ALP_2015\Airport_Layout_Plan\CAD\Property_Map.dwg
 File Name:
 Designed By:
 Checked By:

STATE OF ALASKA DEPARTMENT OF TRANSPORTATION AND PUBLIC FACILITIES CENTRAL REGION		DATE: 5/04/2016 SHEET: 12 OF 12
CHEVAK AIRPORT CHEVAK, ALASKA AIRPORT LAYOUT PLAN AIRPORT PROPERTY MAP		
5/2016 2/2015 BY DATE	UPDATED PROPERTY STATUS TABLE AS-BUILT PER 56626 AND METRIC TO ENGLISH CONVERSION REVISION	